

*Diamant* 



# 2025 MAHON/NHOMA

SERVICE MANUAL

# Contents

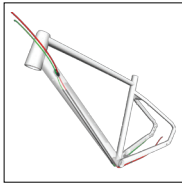

[Routing – brake and shift](#)



[Routing – lights \(rigid fork\)](#)

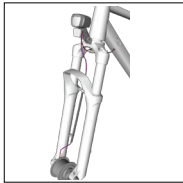

[Routing – lights \(suspension fork\)](#)



[Dropouts – internal gear hub](#)

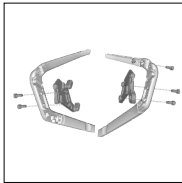

[Dropouts – rear derailleur](#)

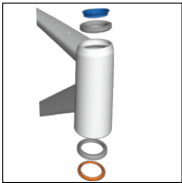

[Headset](#)

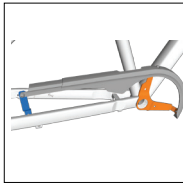

[Chainguard](#)

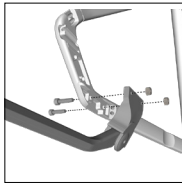

[Kickstand](#)

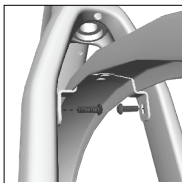

[Front fender](#)



[Rear rack and fender](#)



Frame Size		Front	130 mm
		Head	130 mm
		Seat	250 mm
		Chain	50.1 mm
Rear wheel diameter (mm)		Front	400/130 mm
		Rear	400/130 mm
Wheel mounting			400 mm (130 mm)
Chain line			400 mm (130 mm)
Rear wheel diameter			400 mm (130 mm)
Rear wheel axle diameter			10 mm

[Specifications](#)



# About this manual

## Scope

This manual contains parts diagrams, specifications (such as grease and torque values), instructions, part numbers, and helpful tips. It does not contain instructions for all components (such as brake calipers). Refer to the original manufacturer for more information.

## Additional info

The Owner's Manual is available at [Trebikes.com/manuals](https://trekbikes.com/manuals).

## Inspect the bike

Please inspect the bicycle carefully after removal from the box and all packaging:

- Inspect all surfaces of the bicycle for damage, pay special attention to the fork legs and the seat stays (both inside and outside surfaces).
- If packaging damage is located near the front of the bicycle, remove the fork from the frame and inspect the steerer tube for damage.

## Replacement parts

Trek recommends using only Trek OEM (original manufacturer) replacement parts.

## Legend

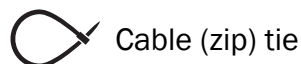

Cable (zip) tie



Torque value



Apply appropriate threadlocker



Apply Bontrager grease

## Safety



### WARNING

#### Properly tighten hardware

Always tighten hardware to the specified torque. Over-tightening hardware could deform or break the hardware or components. Under-tightening or over-tightening hardware could cause hardware or components to become loose. Either situation could damage the bicycle and result in injury to the rider.







### WARNING

#### Reapply threadlocker

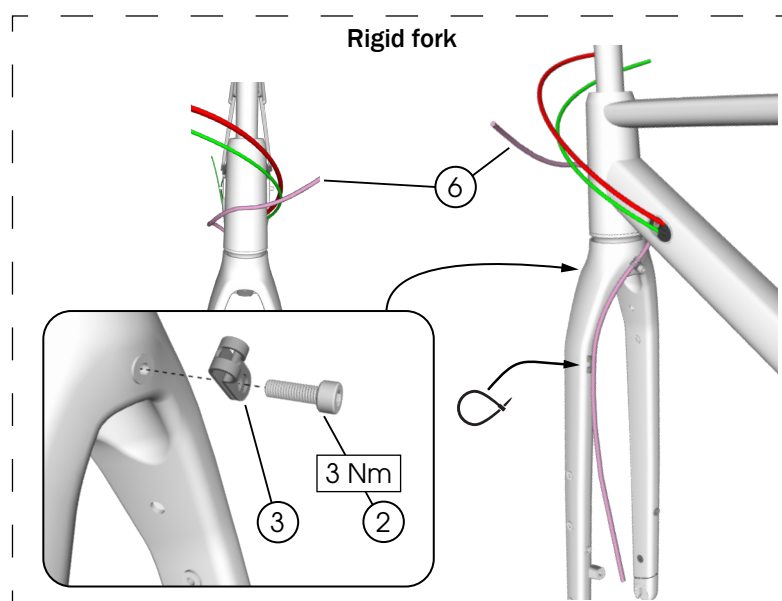
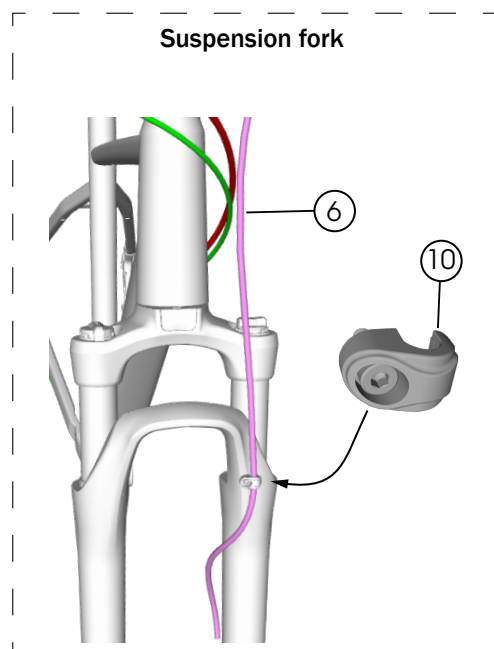
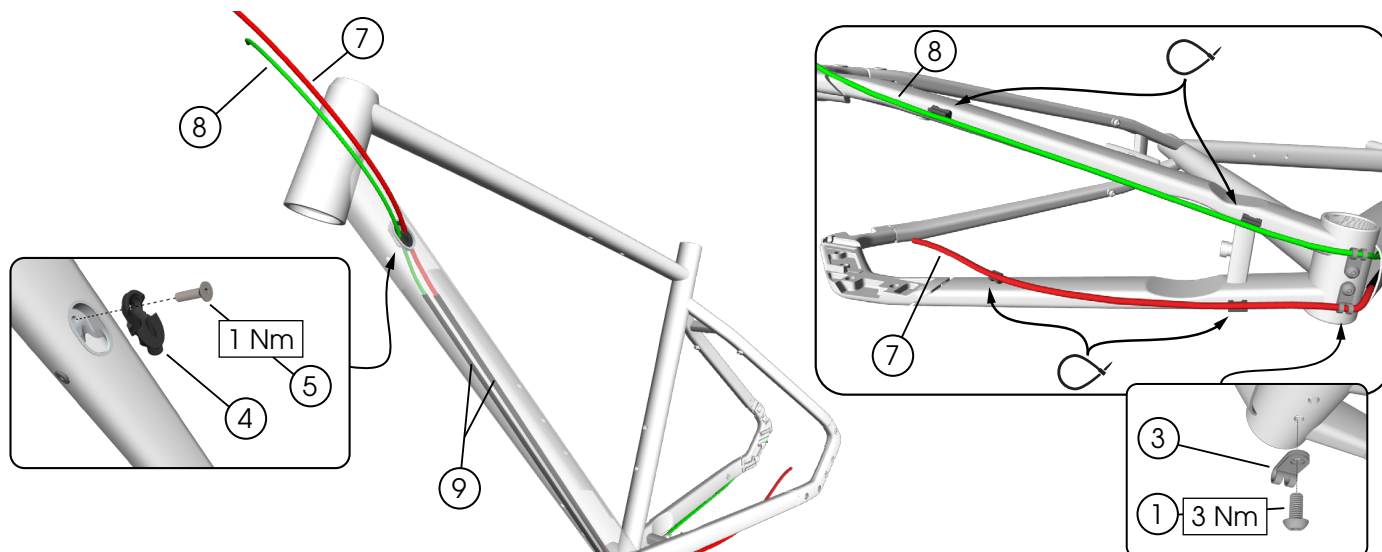
All reused-fasteners with pre-applied threadlocker must be cleaned with isopropyl alcohol and have new threadlocker applied before re-assembly. If threadlocker is not applied, the fasteners may loosen which could damage the bicycle and result in injury to the rider.

# Routing — brake and shift

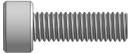

- ① Fasteners (M5 x 8 mm) — W598484 
- ② Fastener (M5 x 16 mm) — W596821 
- ③ Cable guides — W316706
- ④ Control freak guide — W544385
- ⑤ Fastener (M4 x 16 mm) — W532763 
- ⑥ Front brake hose
- ⑦ Rear brake hose

- ⑧ Rear shift cable
- ⑨ Foam sleeves — W528082
- ⑩ Cable guide — 5315601



## Routing — lights (rigid fork)

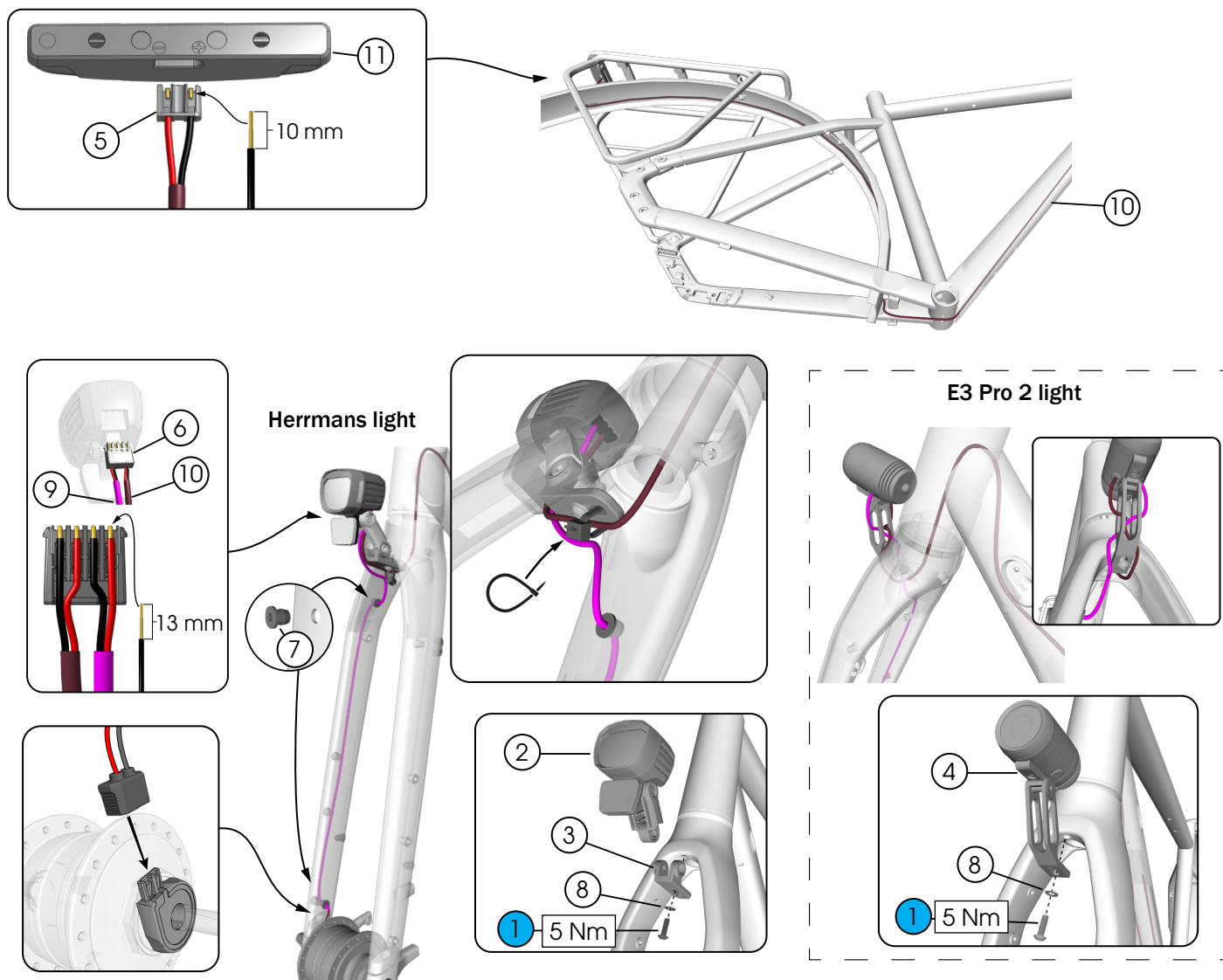

- ① Fastener (M5 x 16 mm) ④
- ② Front light and hardware — W5304404
- ③ Light bracket — 5314337
- ④ E3 Pro 2 light and bracket
- ⑤ Connector, rear — 5307542
- ⑥ Connector, front — 5331539
- ⑦ Grommet — W253694
- ⑧ Washer (M5)
- ⑨ Front light wire

## Routing — lights (suspension fork)

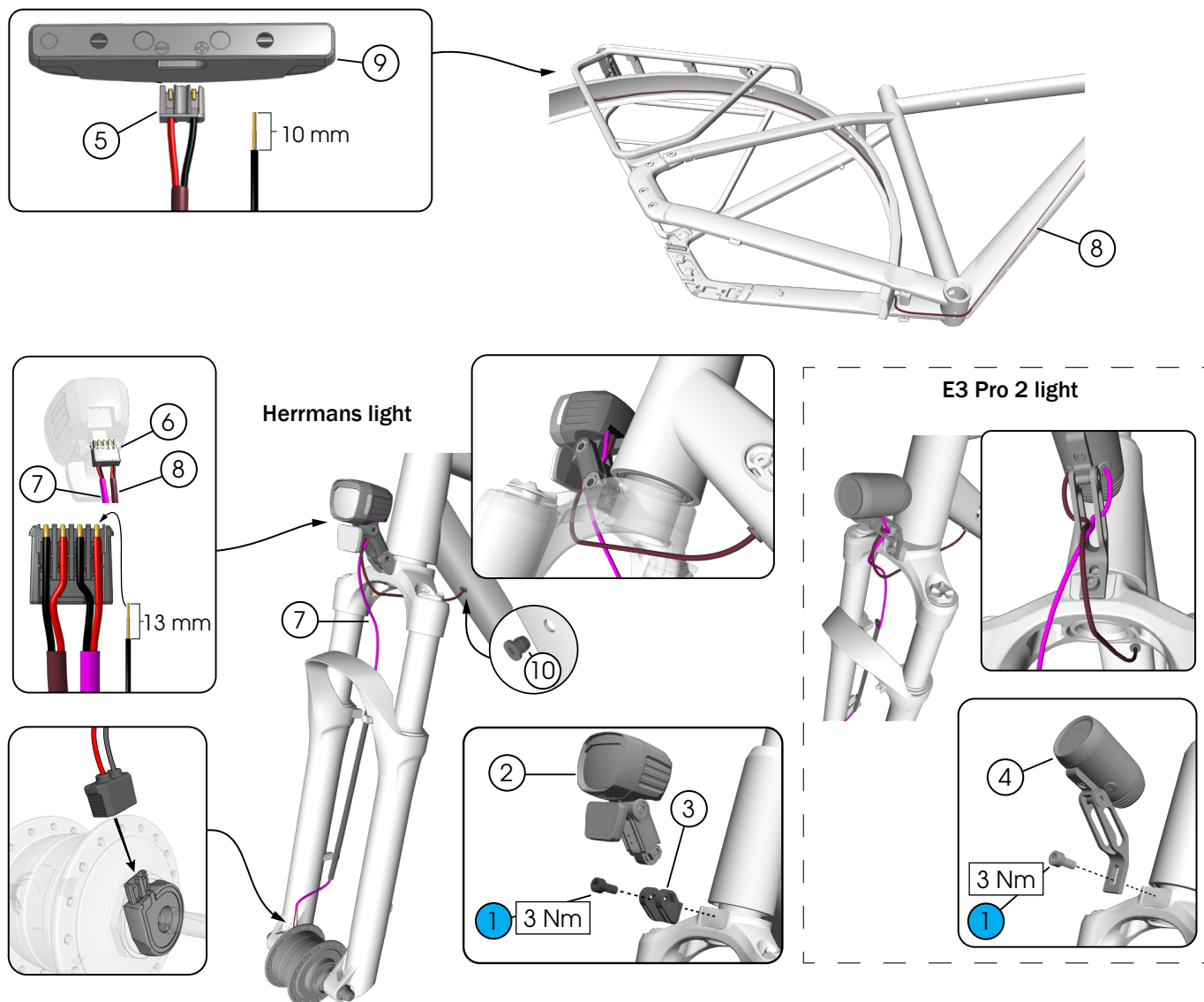

- ① Fastener (M5 x 12 mm)
- ② Front light and hardware — W5304404
- ③ Light bracket — 5314337
- ④ E3 Pro 2 light and bracket
- ⑤ Connector, rear — 5307542
- ⑥ Connector, front — 5331539
- ⑦ Front light wire
- ⑧ Rear light wire
- ⑨ Rear light
- ⑩ Grommet — W253694

## Dropouts — internal gear hub

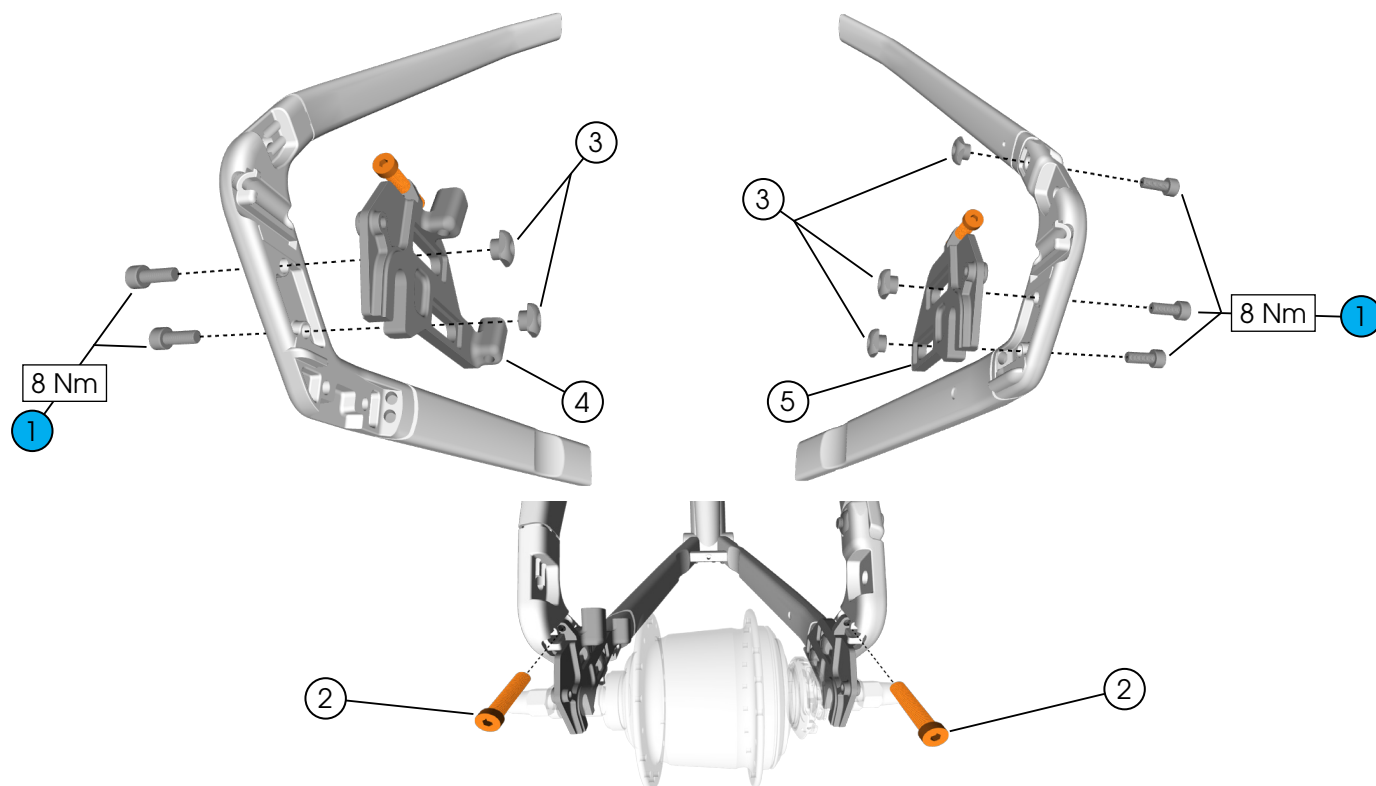

### Adjust belt tension

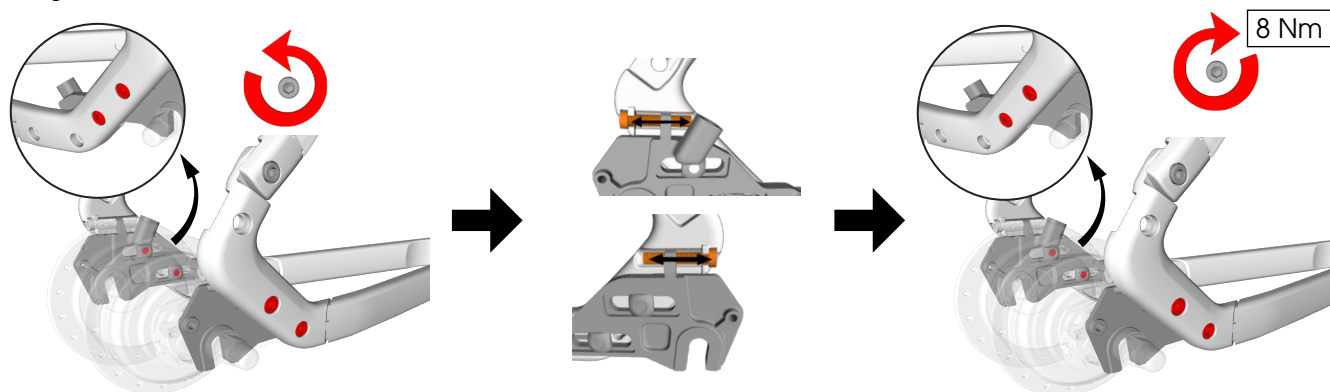

① Fasteners (M6 x 16 mm) — 5332528

② Fasteners (M5 x 30 mm) — 5332529

③ Square nuts (M6) — W53255889

④ Dropout slider, non-driveside

⑤ Dropout slider, driveside

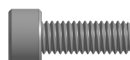

5332526



## Dropouts — rear derailleur

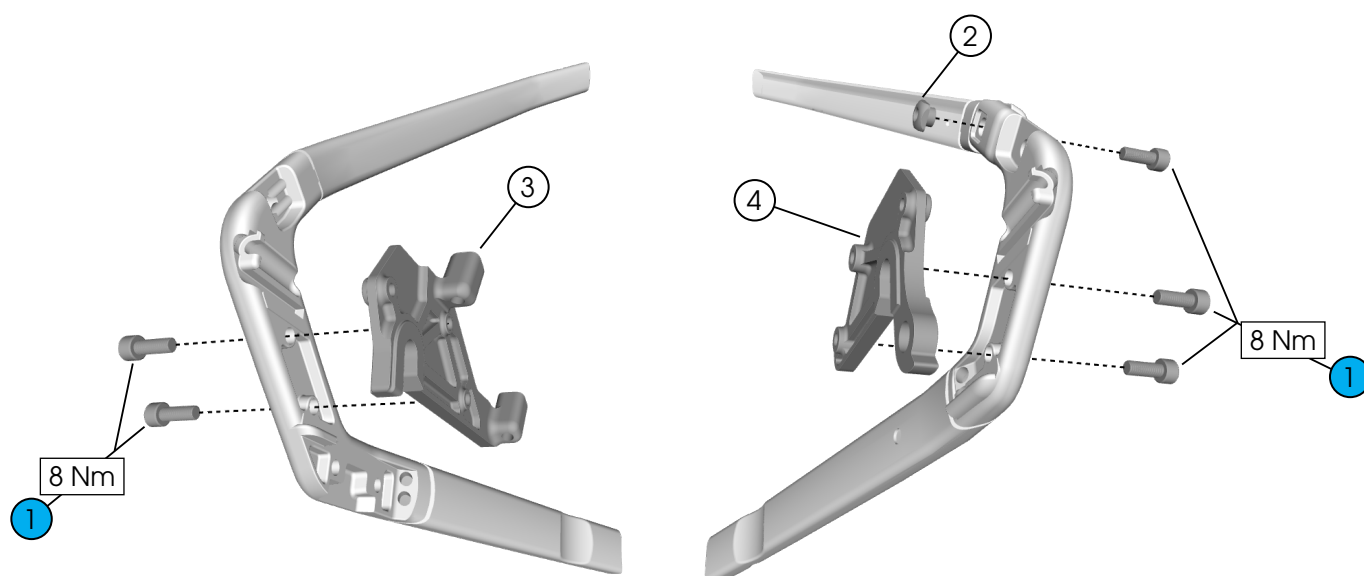

① Fasteners (M6 x 16 mm) — 5332528

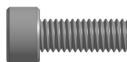

② Square nut (M6) — W53255889

③ Dropout, non-driveside

④ Dropout, driveside

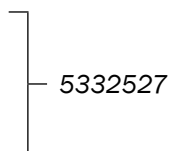

# Headset

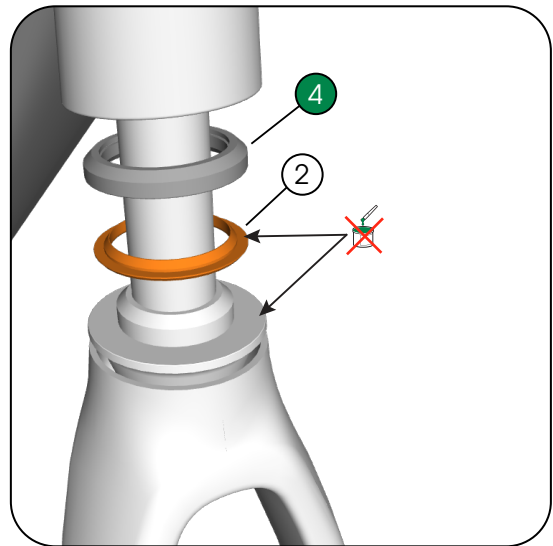
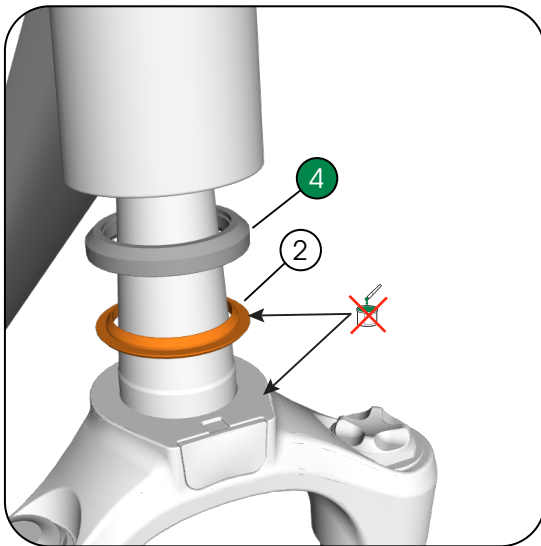
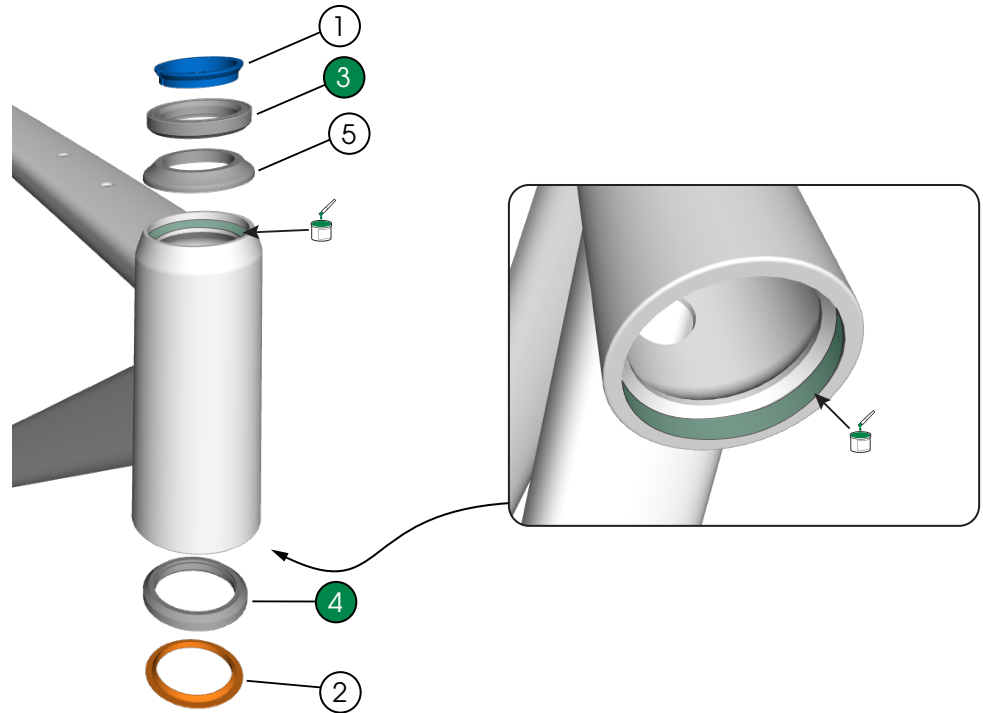

- ① Compression ring — 5321754
- ② Crown race — W532844
- ③ Headset bearing, upper (1 1/8") — W531676
- ④ Headset bearing, lower (1 1/5") — W532843
- ⑤ Bearing top cover — W5283853

# Chainguard

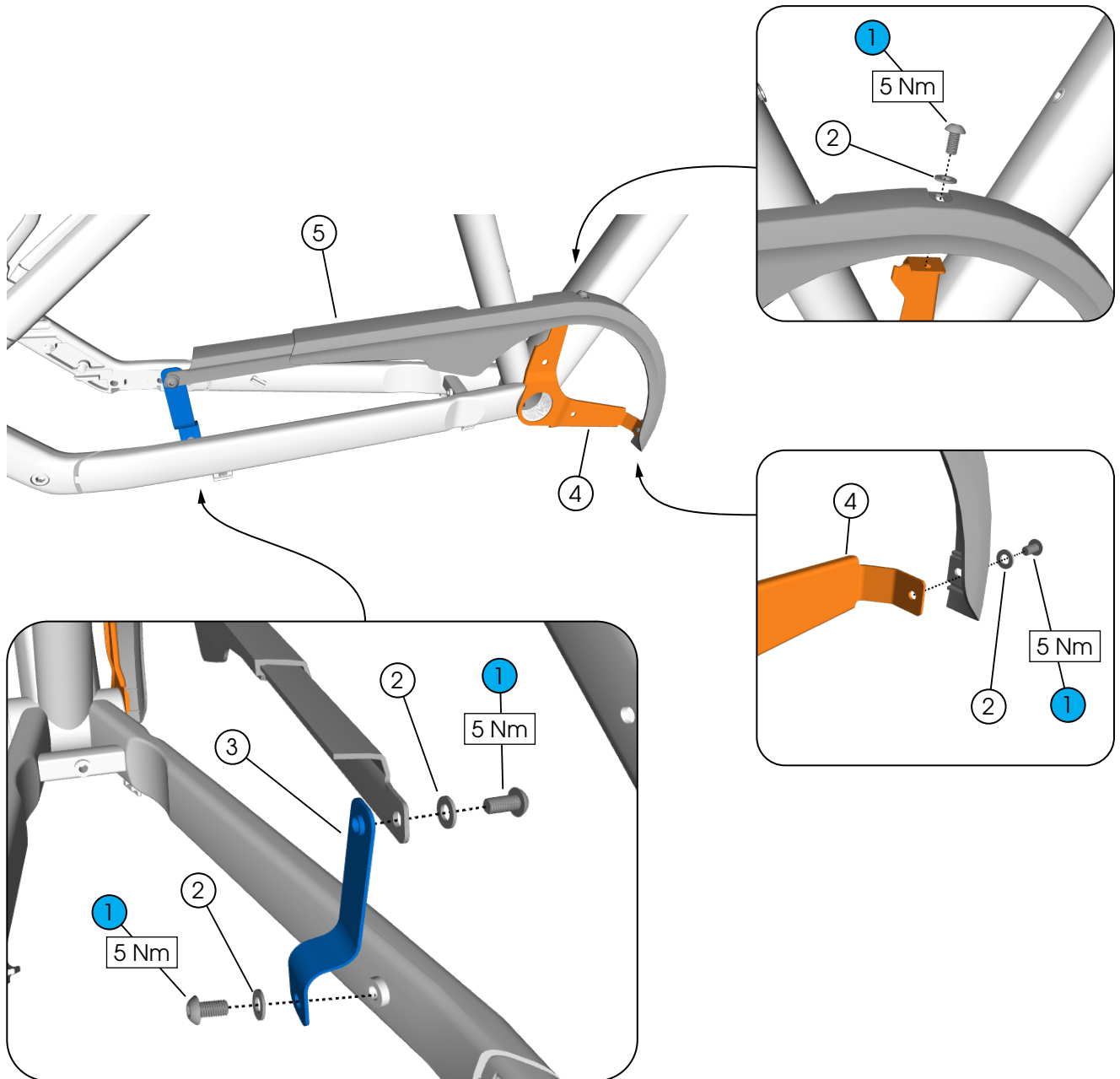

① Fasteners (M5 x 10 mm) — W549305

② Washers (M5) — 5317316

③ Bracket — W558781

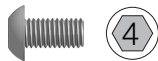

④ Chainblade bracket — W600178

⑤ Chainguard

W540375



# Kickstand

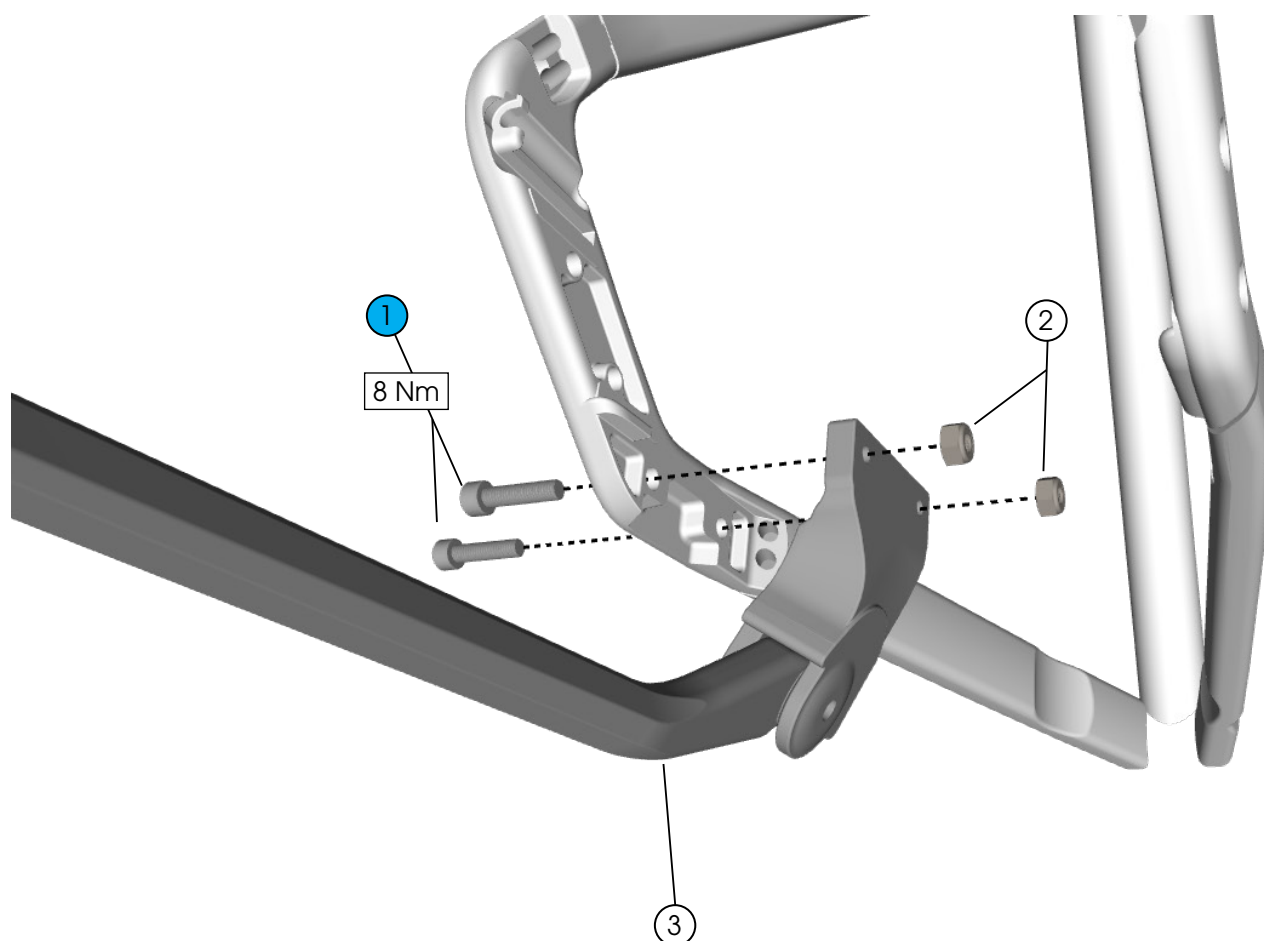

① Fasteners (M6 x 25 mm)

② Nylock nuts (M6)

③ Kickstand – W330288

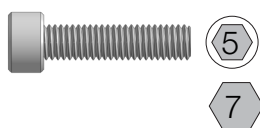

# Front fender

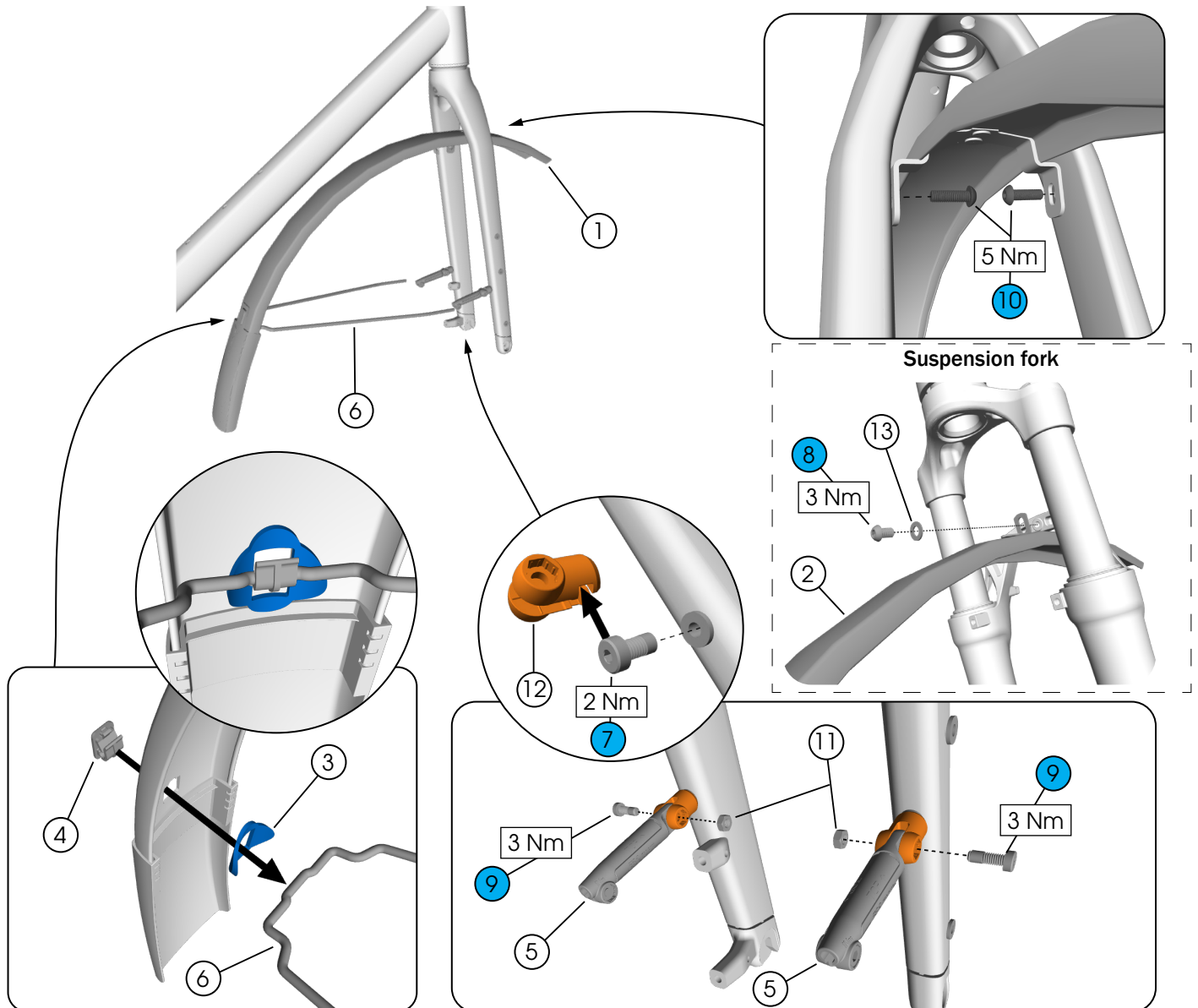

① Fender (700 x 56 mm) – W5331969

② Fender (27.5" x 65 mm) – W5335780

③ Damping rubber

④ Stay clip

5258253

⑤ Stay mounts – 5258260

⑥ Fender stay (305 mm) – W5332570

⑦ Fasteners (M5 x 10 mm) – 5317305

⑧ Fastener (M6 x 10 mm) – 5328799

⑨ Fasteners (M4 x 12 mm) – 5305635

⑩ Fasteners (M5 x 16 mm) – 5328801

⑪ Nuts, hexagon (M4) – 5328804

⑫ Stay adapters – W5326167

⑬ Split washer (M6) – 5317315

## Rear rack and fender

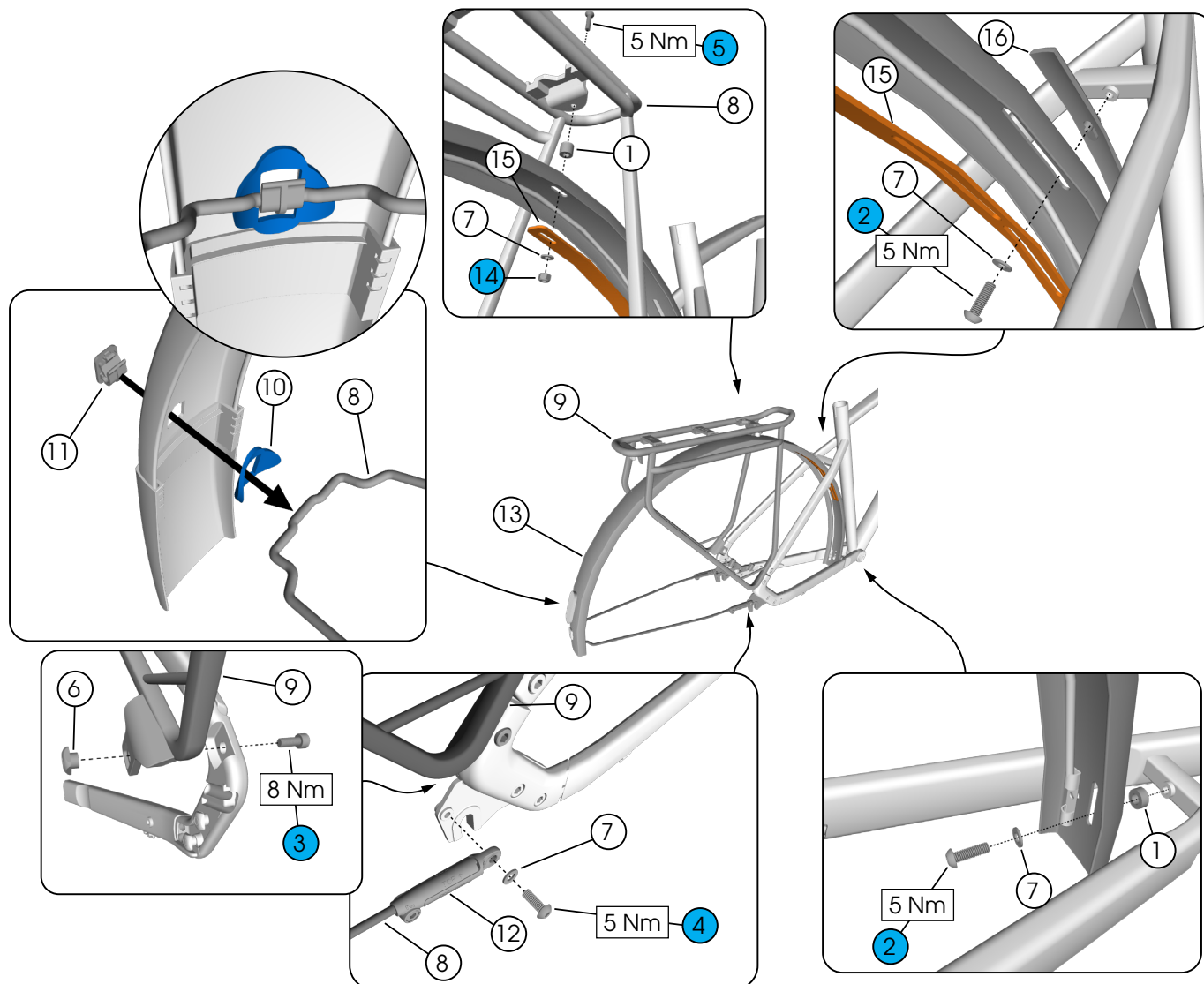

① Spacers (10 mm) – 5260275

② Fasteners (M5 x 16 mm) – W5252787

③ Fasteners (M6 x 16 mm) – 5332528

④ Fasteners (M5 x 14 mm) – 5317304

⑤ Fastener (M5 x 25 mm) – 5328803

⑥ Mounting nuts (M6) – W5325889

⑦ Washers (M5) – W521137

⑧ Strut (335 mm) – W5330899

⑨ Rack – W5324462

⑩ Damping rubber

⑪ Stay clip

⑫ Stay mounts – 5258260

⑬ Fender

⑭ Nylock nut (M5) – 5317577

⑮ Strut – W600320

⑯ Slot cover – W1049294

5258253

S/M/L – W5330900

XL/XXL – W5330901



# Specifications

<b>Hub OLD</b>	Front	100 mm
	Rear	135 mm
<b>Fork steerer tube OD</b>	Upper	28.6 mm
	Lower	38.1 mm
<b>Brake rotor diameter min/ max</b>	Front	160/180 mm
	Rear	160/180 mm
<b>Max chainring</b>		48T chain / 50 belt
<b>Chain line</b>		49.6 mm chain / 45.5 mm belt
<b>Seatpost diameter</b>		31.6 mm
<b>Tire width max 622 mm</b>		*50 mm

*\*as measured when the tire is seated on the rim*