

Diamant 



2025 SUVEA

SERVICE MANUAL

Contents

Routing

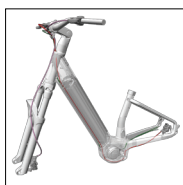

[Routing – Style](#)



[Routing – Trip Plus](#)

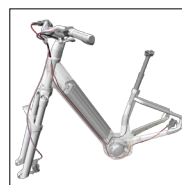

[Routing – Trip Pro](#)

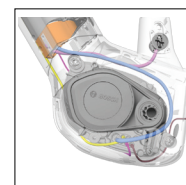

[Routing – e-system](#)

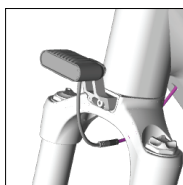

[Routing – front light](#)

Headset

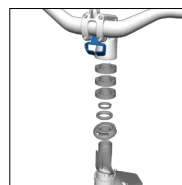

[Headset and stem](#)



[Install the headset](#)

E-system

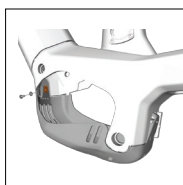

[Drive unit cover](#)

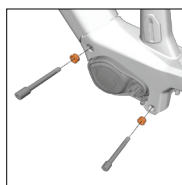

[Drive unit](#)



[Battery cover](#)

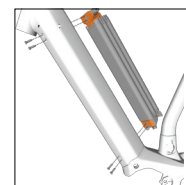

[Battery assembly](#)

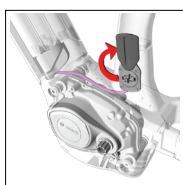

[Charge socket](#)

IGH

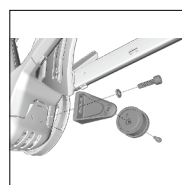

[Belt tensioner \(Style\)](#)

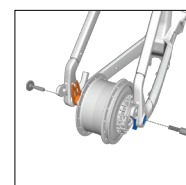

[Internal gear hub \(Style\)](#)

Frame

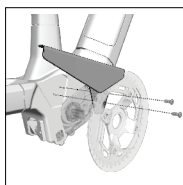

[Chainguard](#)

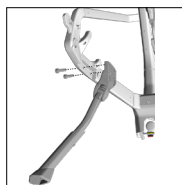

[Kickstand](#)

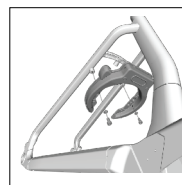

[Ring lock](#)

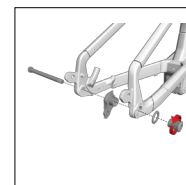

[Rear derailleur hanger
\(Trip Pro/Trip Plus\)](#)

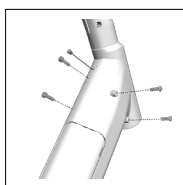

[Frame fasteners](#)

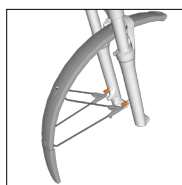

[Front mudguard](#)

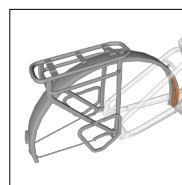

[Rear rack and mudguard](#)

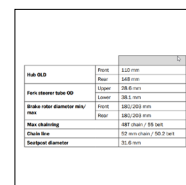

[Specifications](#)

About this manual

Scope

This manual contains parts diagrams, specifications (such as grease and torque values), instructions, part numbers and helpful tips. It does not contain instructions for all components (such as brake callipers). Refer to the original manufacturer for more information.

Additional info

The Owner's Manual is available at [Trekbikes.com/manuals](https://trekbikes.com/manuals).

Inspect the bike

Please inspect the bicycle carefully after removal from the box and all packaging:

- Inspect all surfaces of the bicycle for damage, paying special attention to the fork legs and the seat stays (both inside and outside surfaces).
- If packaging damage is located near the front of the bicycle, remove the fork from the frame and inspect the steerer tube for damage.

Models in this manual

Section headers call out model-specific content throughout this service manual.

- Suvea Trip Pro – rear derailleur, dropper post, Supernova front light
- Suvea Trip Plus – rear derailleur, MR5e front light
- Suvea Style – internal gear hub, MR5e front light

Replacement parts

Trek recommends using only Trek OEM (original manufacturer) replacement parts.

Legend



Cable (zip) tie



Torque value



Apply appropriate threadlocker



Apply Bontrager grease



Apply assembly paste

Safety



WARNING

Tighten hardware properly

Always tighten hardware to the specified torque. Over-tightening hardware could deform or break the hardware or components. Under-tightening or over-tightening hardware could cause hardware or components to become loose. Either situation could damage the bicycle and result in injury to the rider.



WARNING

Re-apply threadlocker

All reused-fasteners with a pre-applied threadlocker must be cleaned with isopropyl alcohol and have new threadlocker applied before re-assembly. If a threadlocker is not applied, the fasteners may loosen, which could damage the bicycle and result in injury to the rider.

Routing - Style

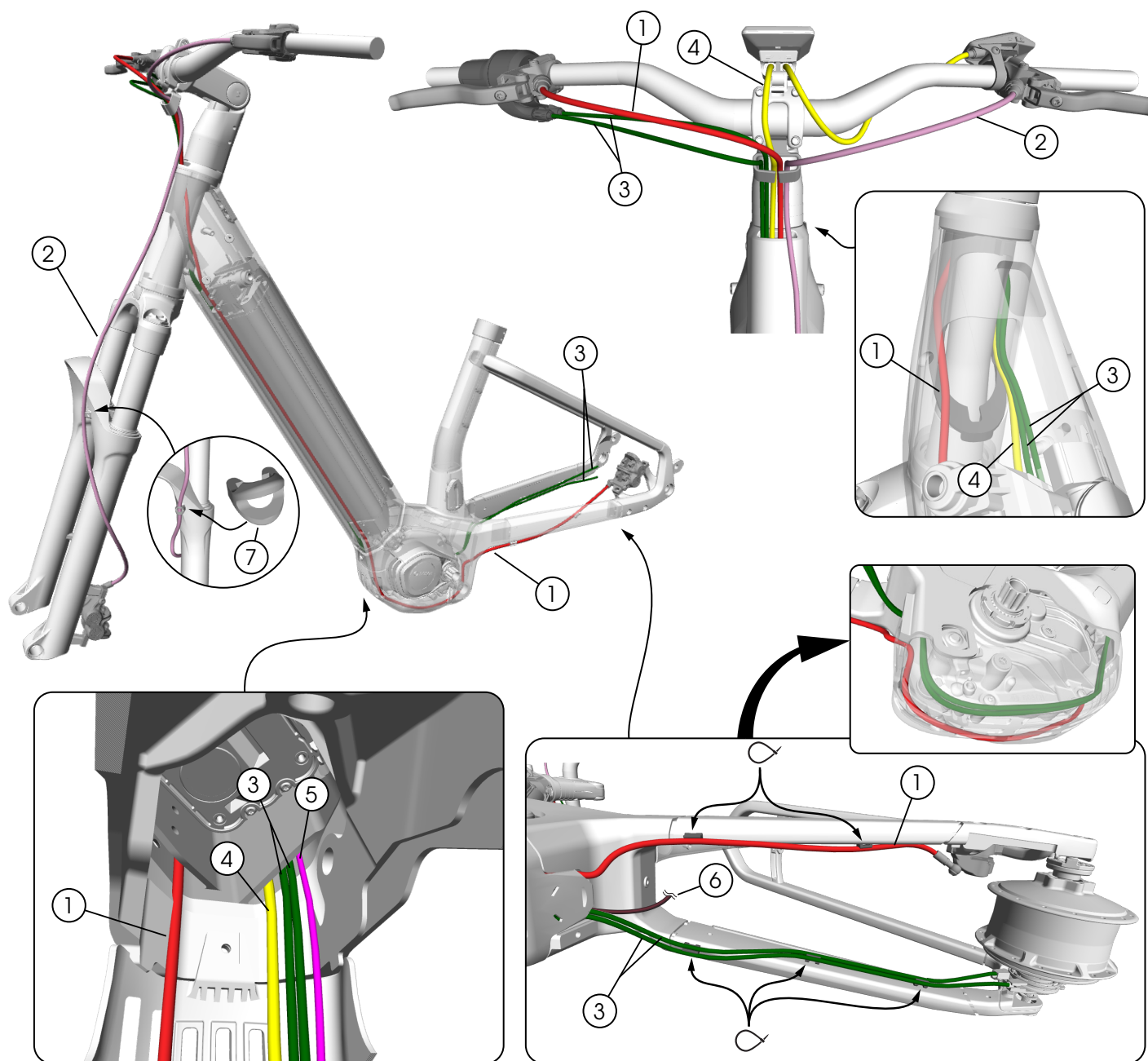

- ① Rear brake hose
- ② Front brake hose
- ③ Internal gear hub cables
- ④ Remote cable – *EB12.120.005
- ⑤ Front light wire – *EB12.120.00H
- ⑥ Rear light wire – *EB12.120.00F

- ⑦ Cable clip – 5315601

*Bosch part number

Routing - Trip Plus

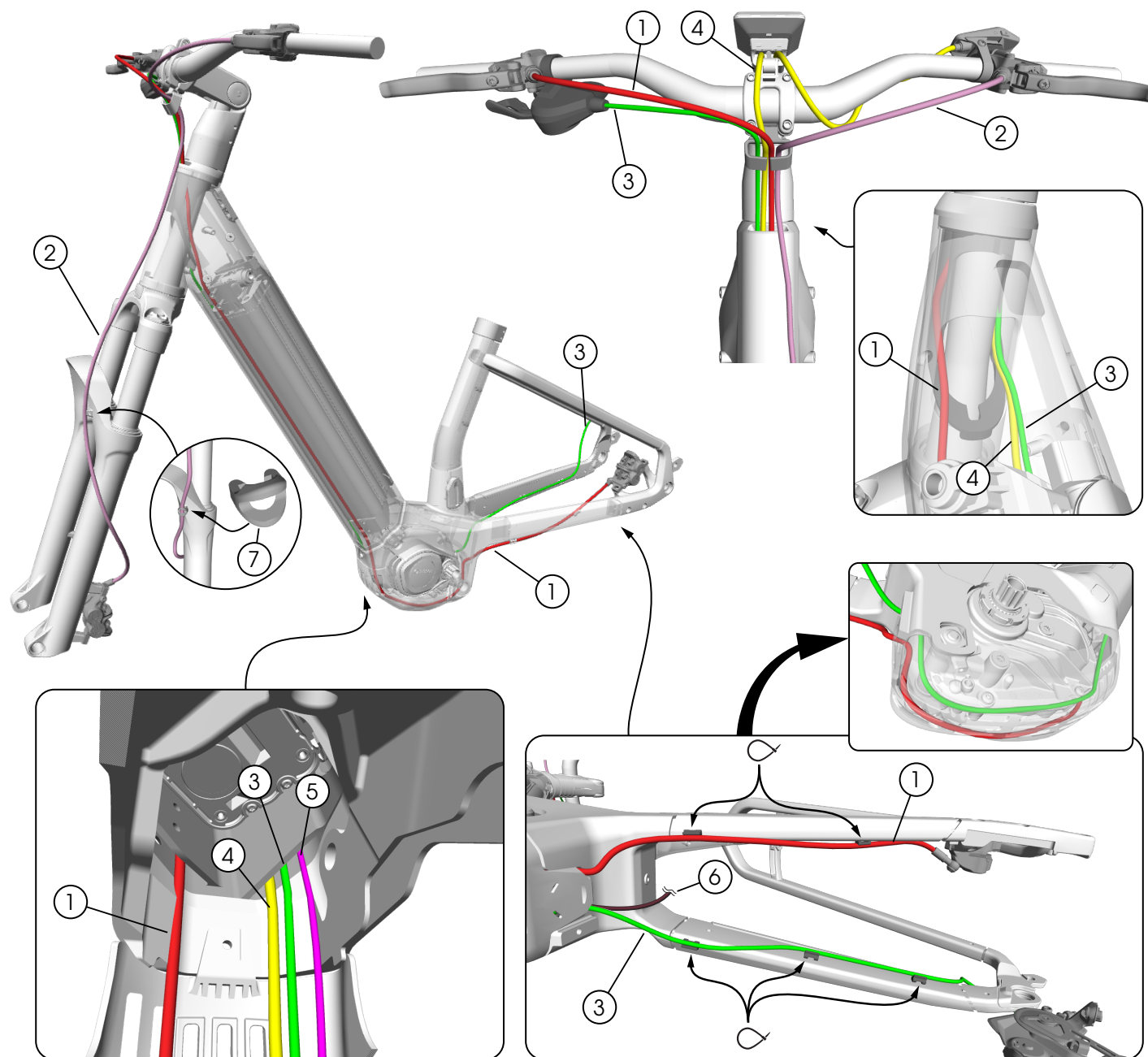

- ① Rear brake hose
- ② Front brake hose
- ③ Rear derailleur cable
- ④ Remote cable – *EB12.120.005
- ⑤ Front light wire – *EB12.120.00H
- ⑥ Rear light wire – *EB12.120.00F

- ⑦ Cable clip – 5315601

*Bosch part number

Routing - Trip Pro

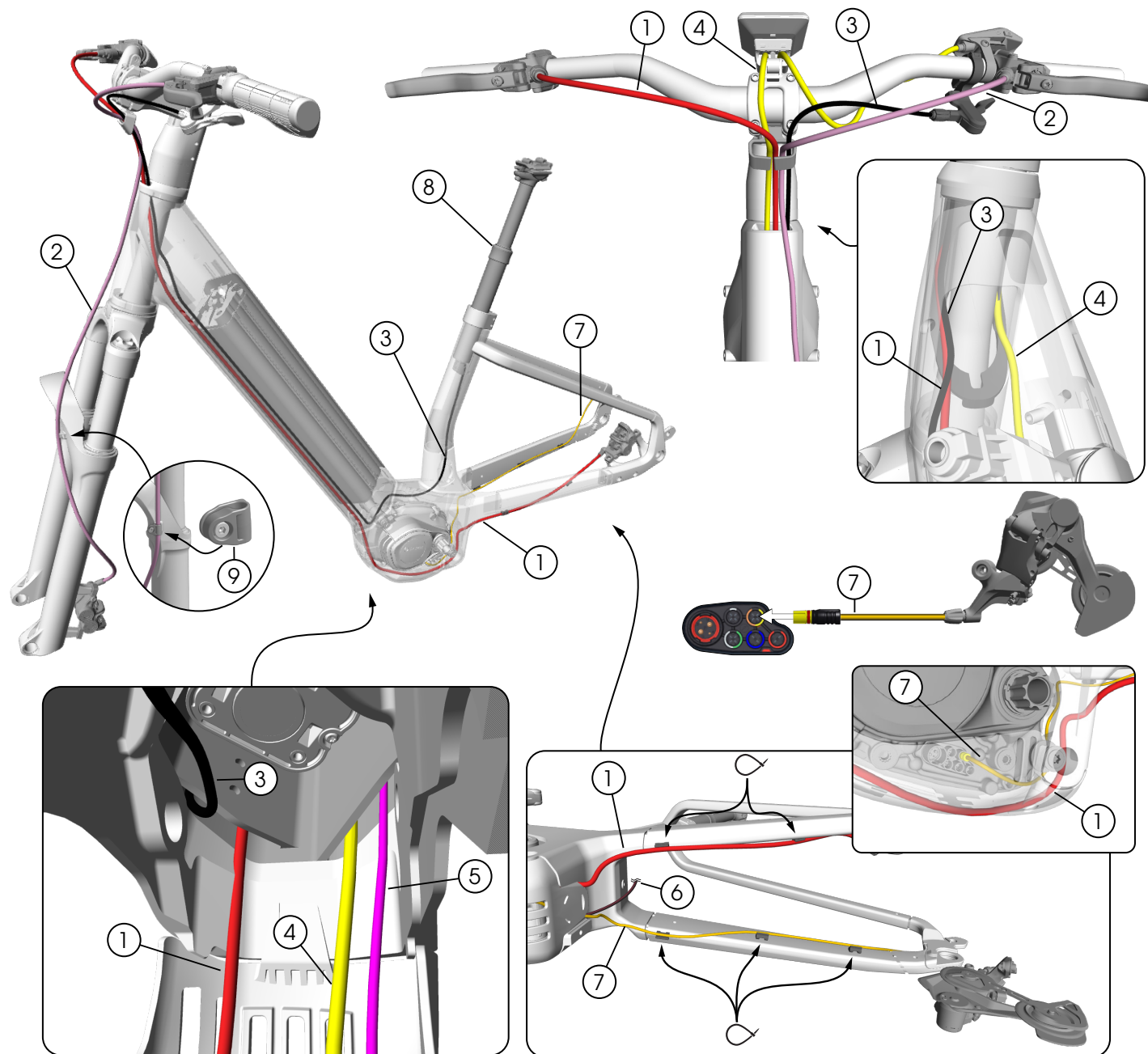

- ① Rear brake hose
- ② Front brake hose
- ③ Dropper post cable
- ④ Remote cable - *EB12.120.005
- ⑤ Front light wire - *EB12.120.00H
- ⑥ Rear light wire - *EB12.120.00F

- ⑦ Di2 wire - **EW-PS300
- ⑧ Dropper post - W5333280
- ⑨ Cable guide - ***820-00-202-KIT

*Bosch part number

**Shimano part number

***Fox part number

Routing - e-system

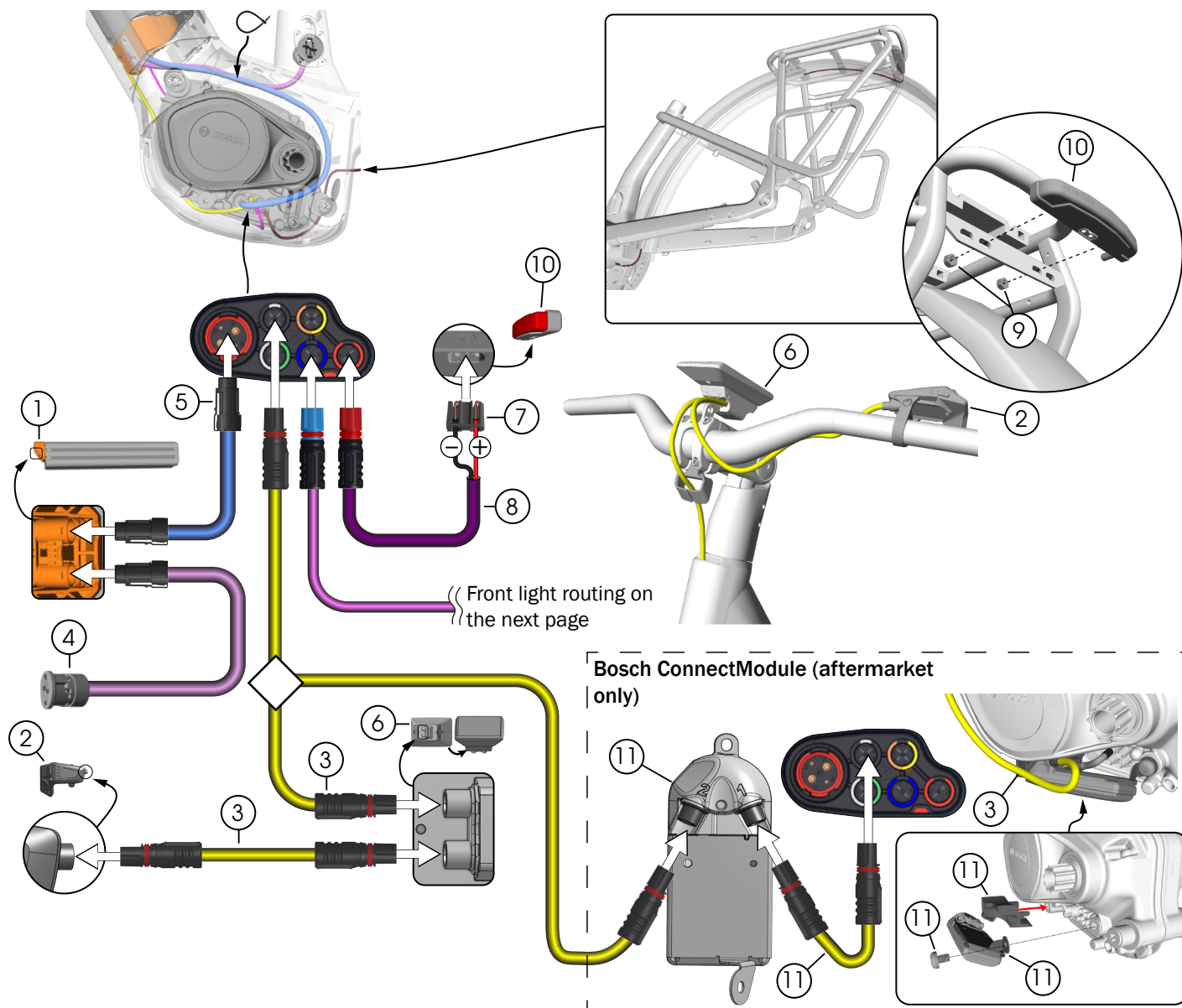

- ① Cradle - *EB12.200.0LJ
- ② Remote - *EB13.100.00E-VE8
- ③ Remote cables - *EB12.120.005
- ④ Charge socket - *EB12.120.02C
- ⑤ Battery cable (600 mm) - *EB12.120.02W
- ⑥ Display - *EB13.100.004
- ⑦ Connector, rear - 5307542
- ⑧ Rear light wire (1,400 mm) - *EB12.120.00F

- ⑨ Nuts (M6)
- ⑩ Rear light - W5294765
- ⑪ Bosch ConnectModule and hardware - *EB13.200.014

*Bosch part number

Routing - front light

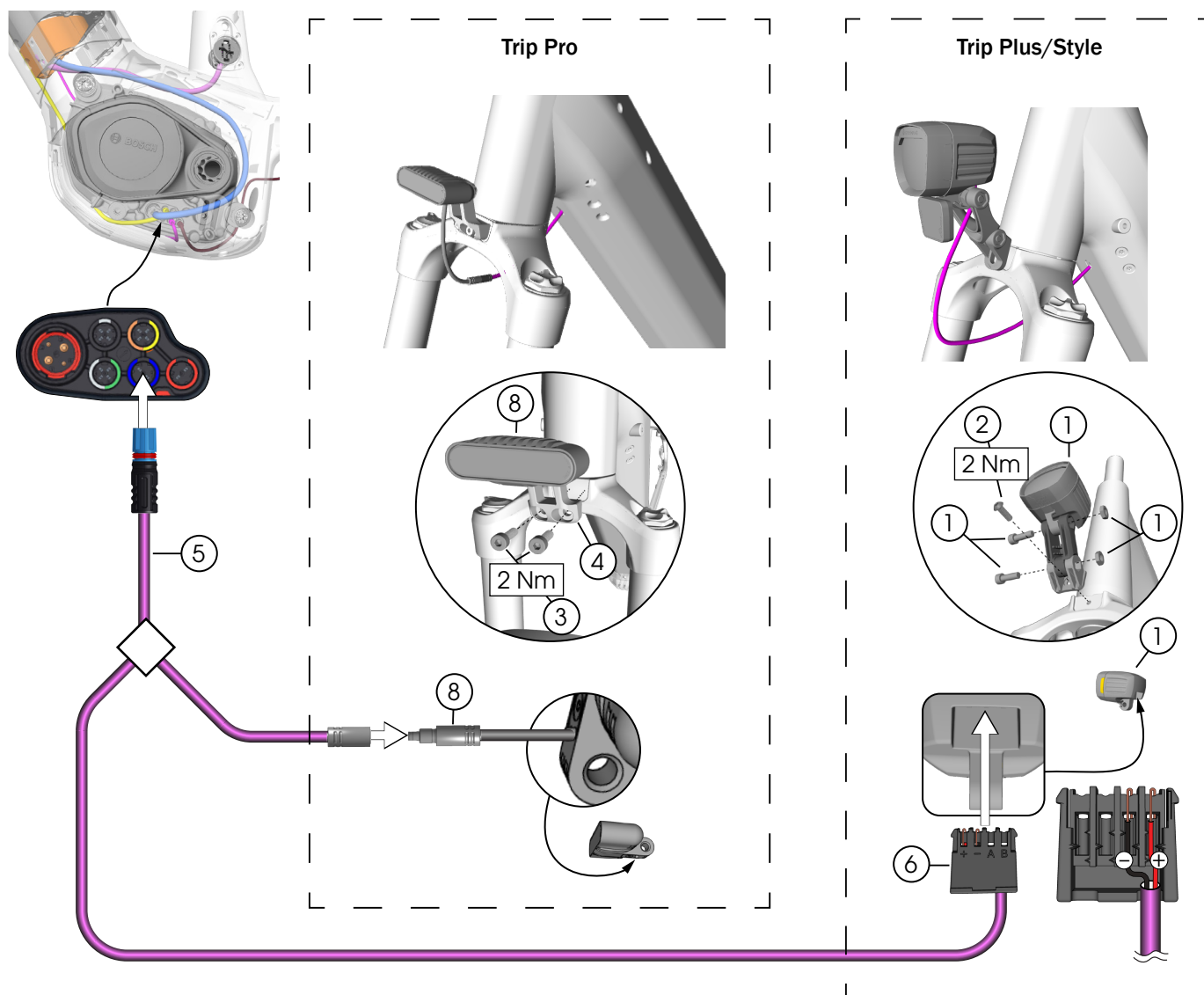

① Front light and hardware – W5304404

**Bosch part number*

② Fastener (M6 x 12 mm)



***Supernova part number*

③ Fasteners (M4 x 12 mm)

④ Light bracket

***V-FXH-BLK*

⑤ Front light wire – **EB12.120.00H*

⑥ Connector – 5331539

⑧ Front light – ***W-SSMPRO-EX*

Headset and stem

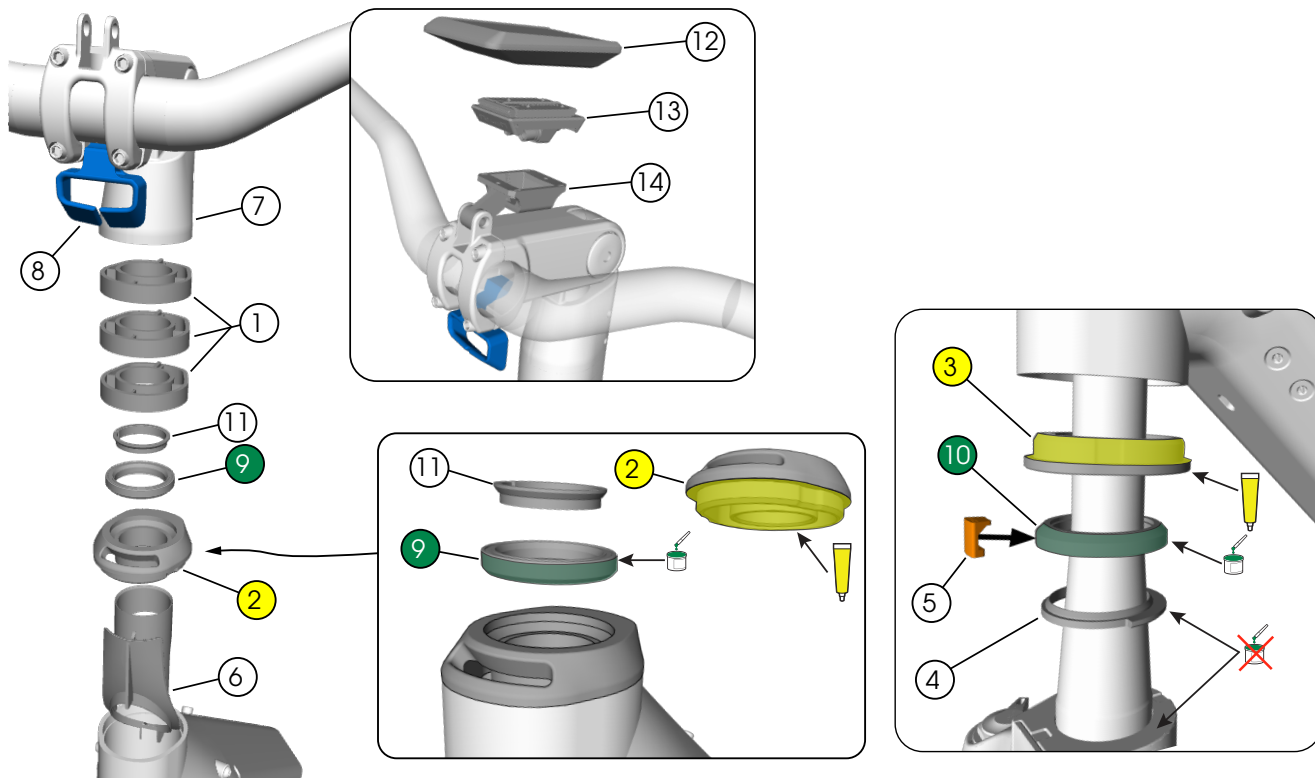

- ① Spacers
 - ② Headset cup, upper
 - ③ Headset cup, lower
 - ④ Crown race
 - ⑤ Knock block
 - ⑥ Cable guide
 - ⑦ Stem (70 mm) – *W5329504
 - ⑧ Cable holder – W5328197
 - ⑨ Headset bearing, upper (1 1/8") – W531676
 - ⑩ Headset bearing, lower (1 1/5") – W532843
 - ⑪ Compression ring – W532842
 - ⑫ Display – **EB13.100.004
 - ⑬ Display interface – **EB13.100.009
 - ⑭ Display mount – ***6031301
- 5333324

**Bosch part number

***Ergotech part number

Asymmetrical steering

If the turning radius is asymmetrical, the knock block/crown race is not aligned and you must disassemble the lower headset and follow steps 6 to 10 on page 10

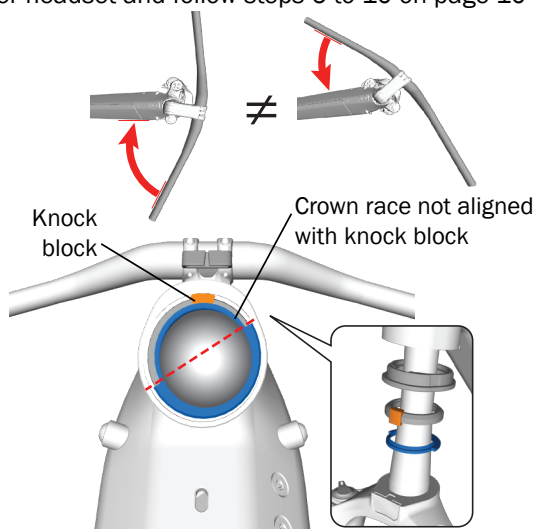

*See Trek bikes.com for all compatible stems

Install the headset

1. Apply assembly grease to the lower headset cup and use a bearing press to install it.



2. Apply assembly grease to the upper headset cup and connect it to the cable guide.

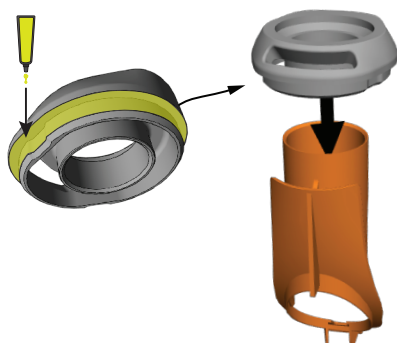

3. Insert the assembly into the head tube and use a bearing press to install it.

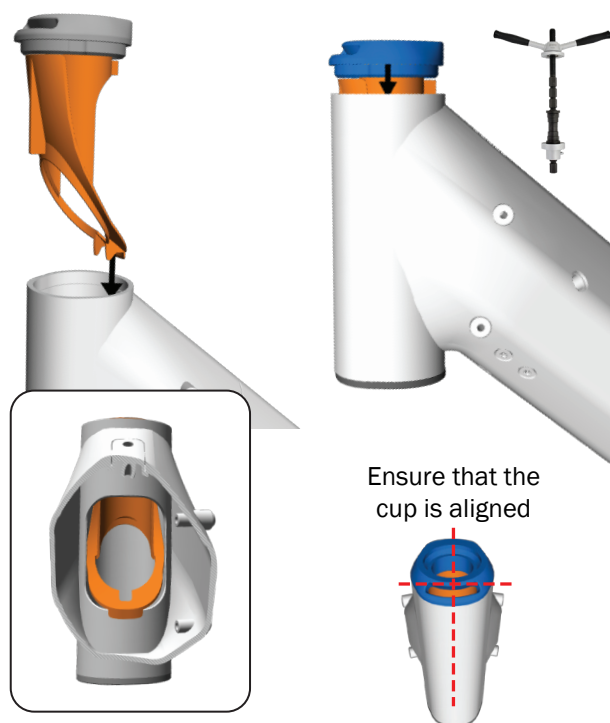

4. Route all cables through the headset.

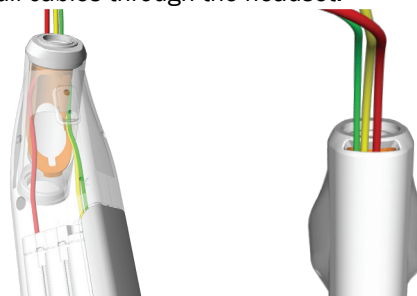

Install the headset (continued)

5. Grease the upper bearing and insert it into the upper cup with the compression ring.

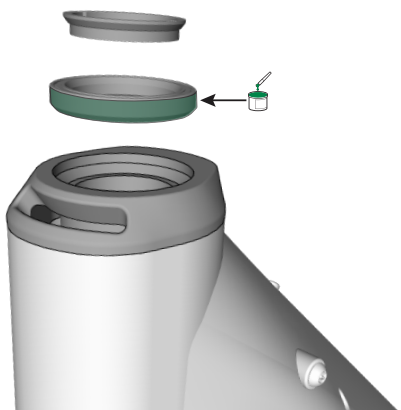

6. Use a crown race setter to install the crown race onto the fork.

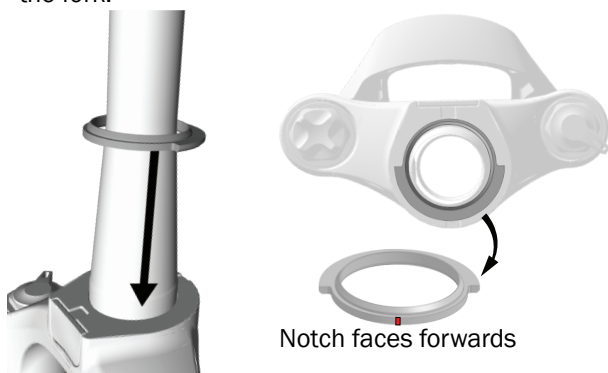

7. Grease the lower bearing, assemble the knock block to the bearing and slide it onto the fork. Then insert the fork into the head tube.

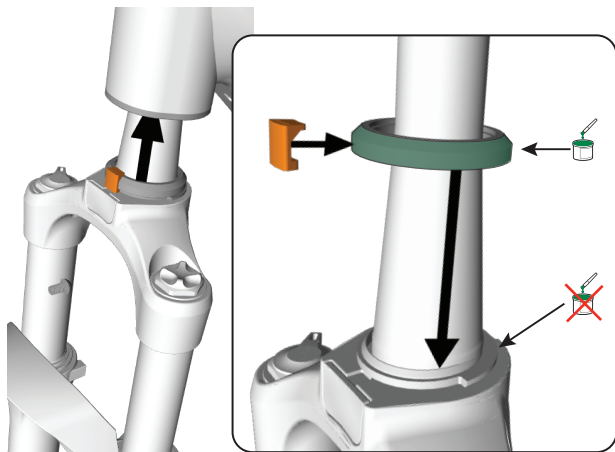

8. Slide the spacers and stem down the steerer tube.

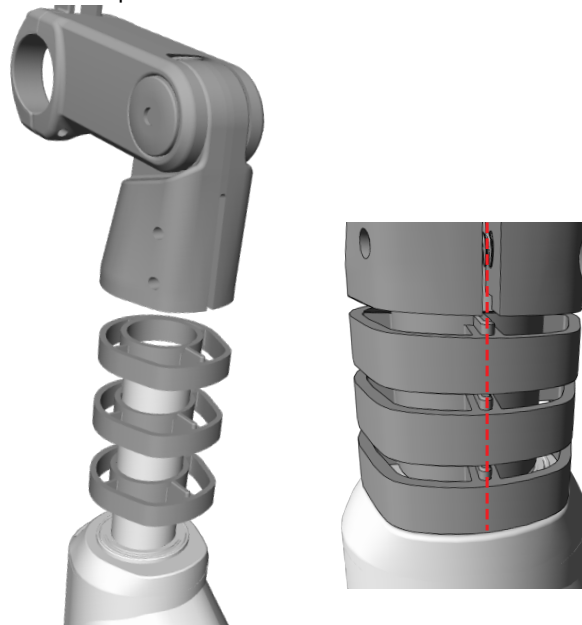

9. Tighten the quill stem fastener (M6 x 50 mm) to 2 Nm.

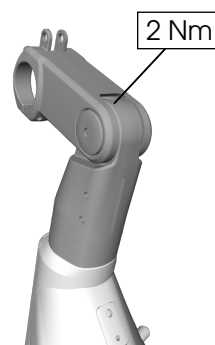

10. Tighten the stem bolts to 11 Nm.

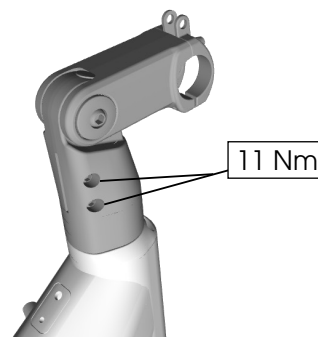

Drive unit cover

Early production motor cover

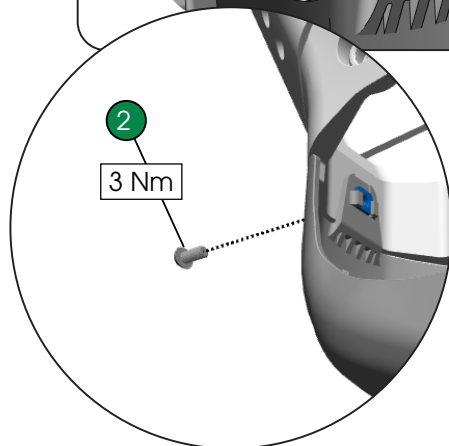
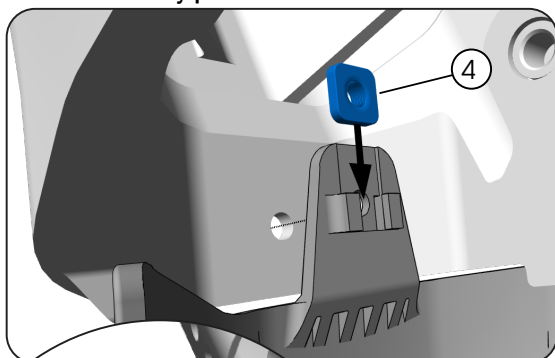

Updated motor cover

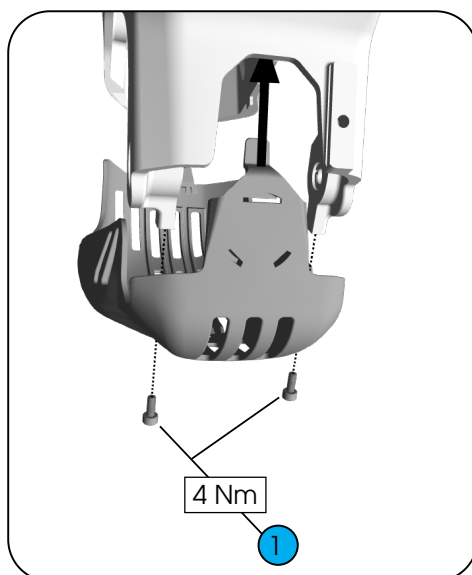
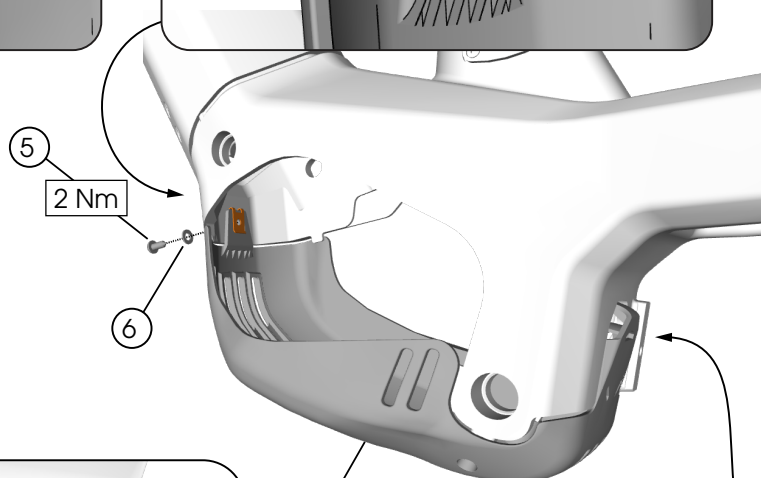
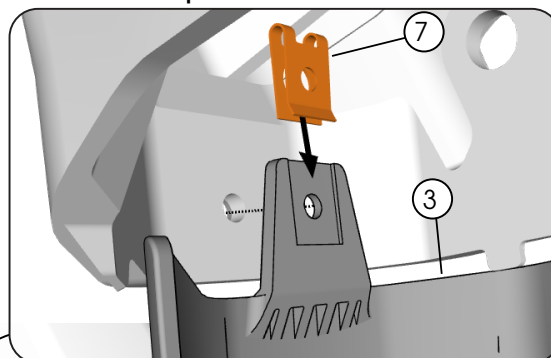

Apple AirTag® (aftermarket only)

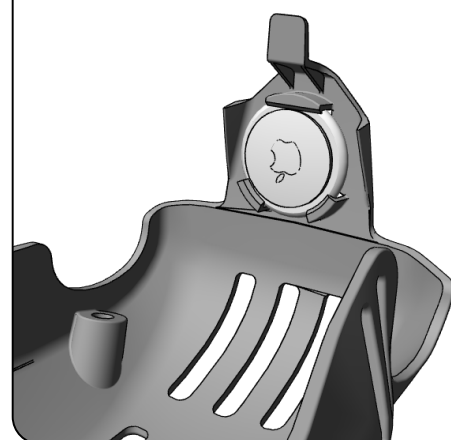

① Fasteners (M4 x 10 mm) – 5317308

② Fastener (M5 x 10 mm) – 5317306

③ Motor cover – W5342014

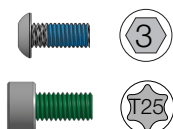

④ Mounting nut (M5) – W5251640

⑤ Tap fastener (M4.8 x 13 mm)

⑥ Washer (M5)

⑦ Sheet nut (M4.8)



5284548

Drive unit

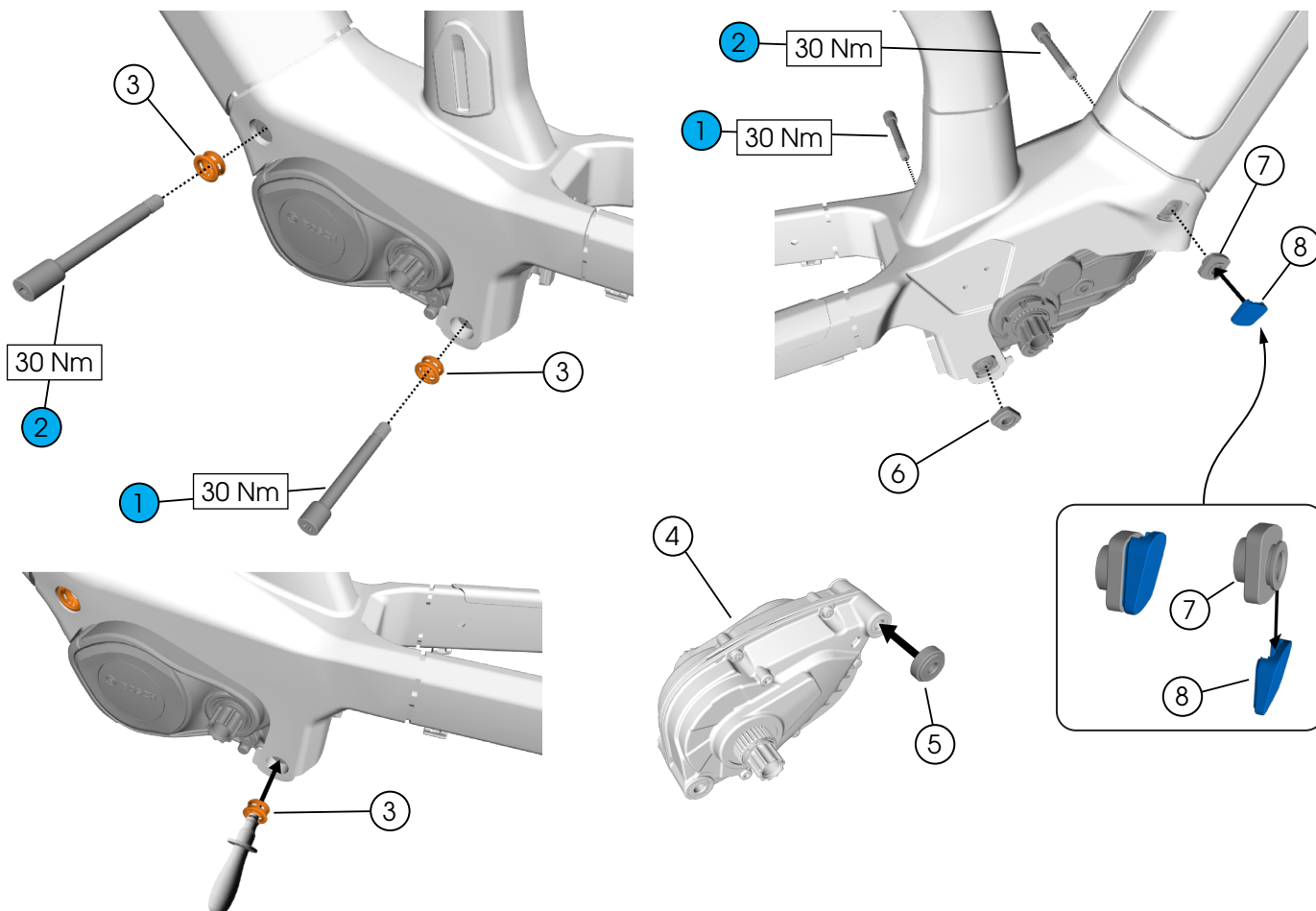

NOTE: Use a Bosch press-in/out tool (such as Cyclus P/N 2124349) to install the sleeves.

① Fastener, short (M8 x 68.7 mm) – *EV11.200.15G



② Fastener, long (M8 x 95.8 mm) – *EV11.200.15J





③ Sleeves – *EV11.200.15H

④ Drive unit – *EB11.100.00E

⑤ Spacer – *EB11.200.0T9

⑥ Nut-square (M8)  *EB11.200.03C

⑦ Nut-square (M8)   W5317916

⑧ Cover

*Bosch part number

Battery cover

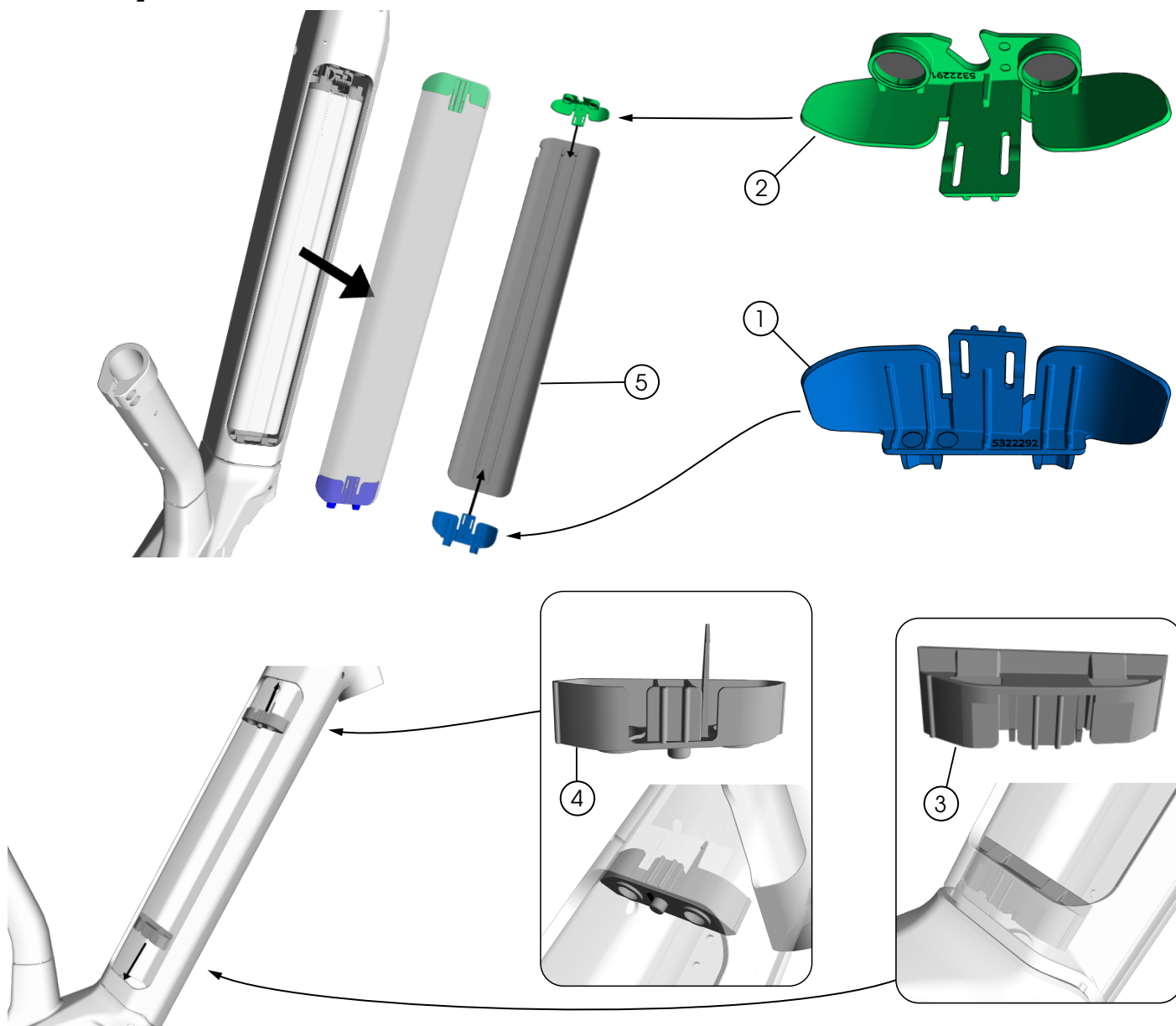

NOTICE: If you remove either bracket, you must replace the part. The locking mechanism clicks into place and removing the brackets may damage them.

- | | | |
|---|--------------------------------------|-----------|
| ① | Bracket cover, bottom | } 5334302 |
| ② | Bracket cover, top | |
| ③ | Bracket, top | |
| ④ | Bracket, bottom | |
| ⑤ | Battery cover (Lehmbeige) - *5334303 | |

**Colour matched part – see Trek bikes.com for full product list*

Battery assembly

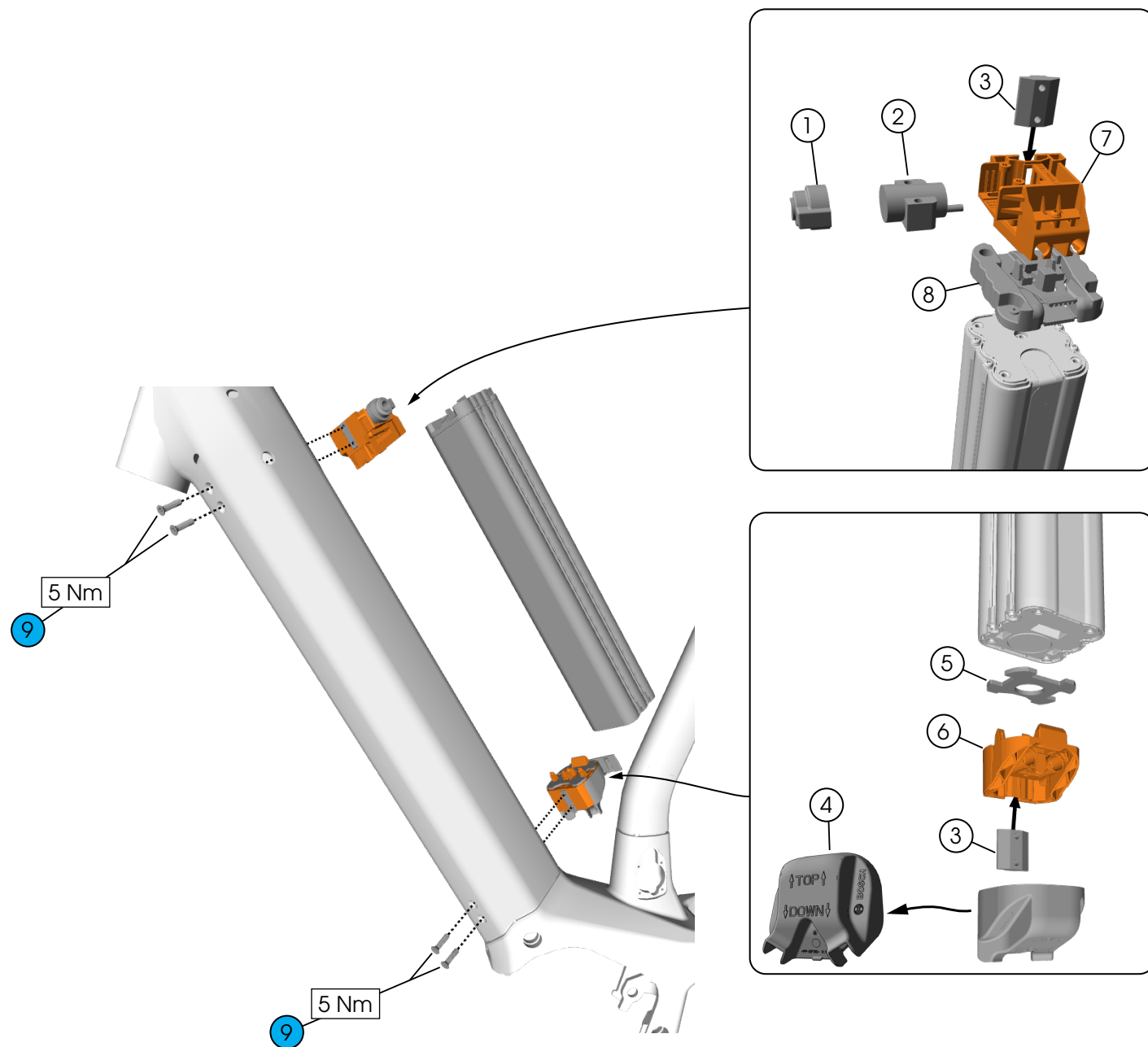

- ① Lock grommet – W5328196
- ② Lock – W5331910
- ③ Clamping plates – *EB12.200.0LG
- ④ Cap – *EB12.200.0MF
- ⑤ Damper foil – *EB12.200.0LK
- ⑥ Cradle – *EB12.200.0LJ

- ⑦ Locking assembly – *EB12.200.0L7
- ⑧ Mounting plate – *EB12.200.0L3

- ⑨ Fasteners (M5 x 16 mm) – 602529

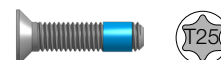

*Bosch part number

Charge socket

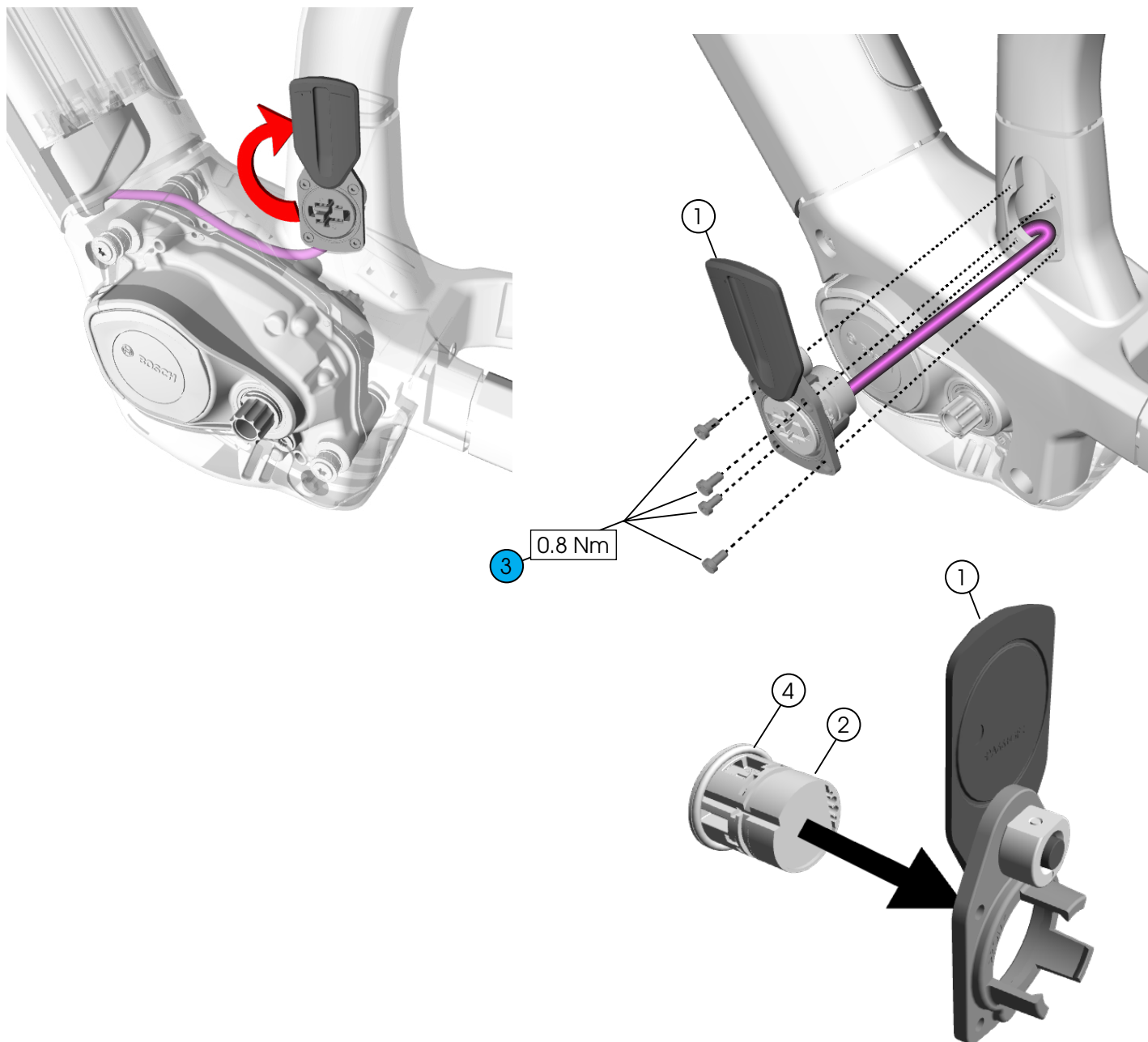

① Charge port assembly – W5307772

② Charge socket – *EB12.120.02C

③ Fasteners (M3 x 6 mm) – W5276241

④ O-ring – *EB12.120.019



*Bosch part number

Chainguard

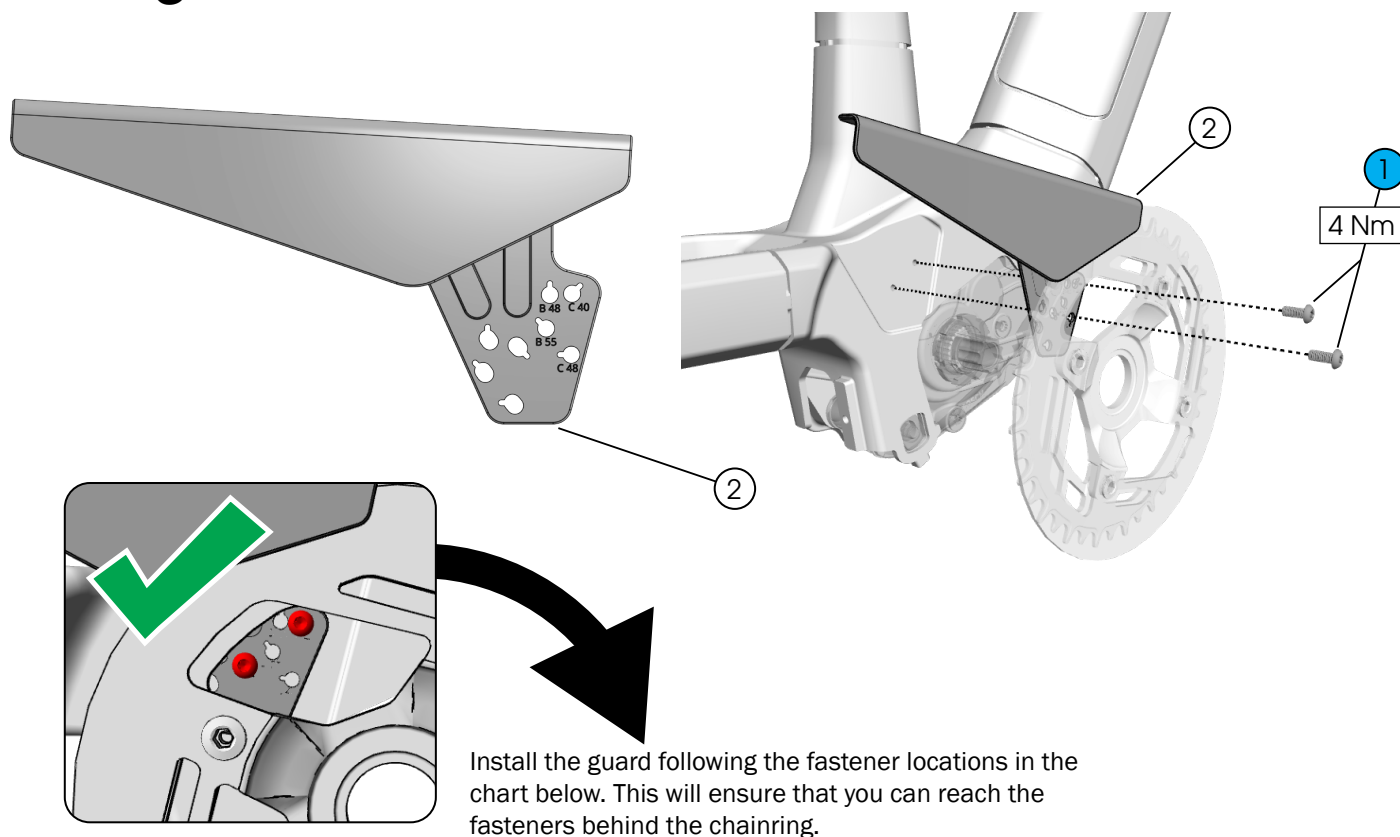

Belt drive

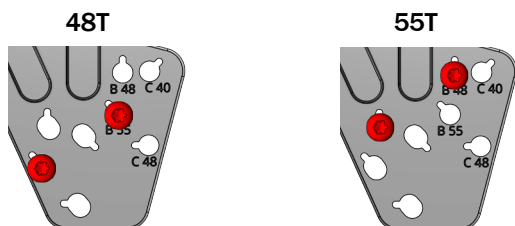

Chain drive

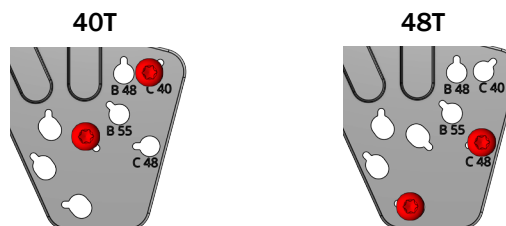

① Fasteners (M4 x 10 mm)



② Chain guard bracket - W5323172

Belt tensioner (Style)

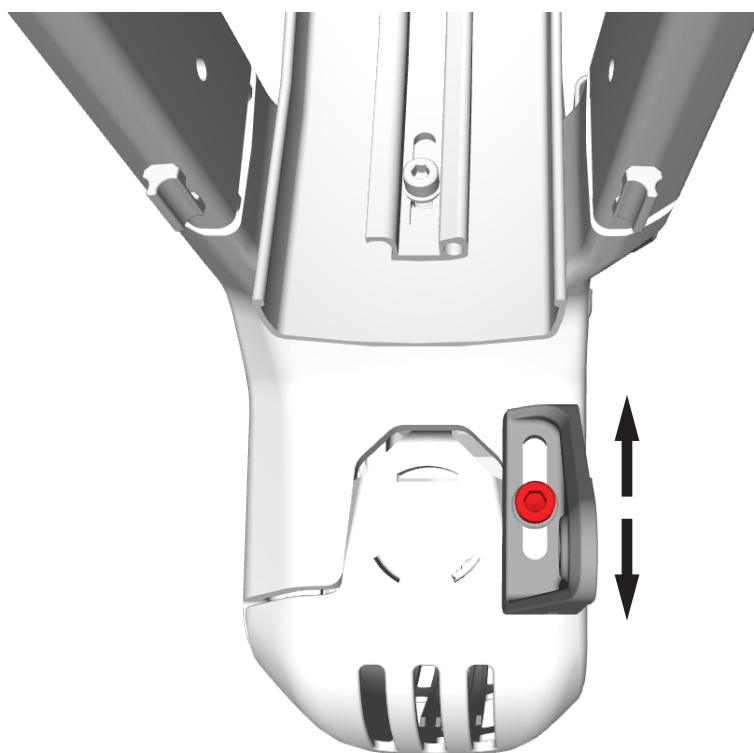
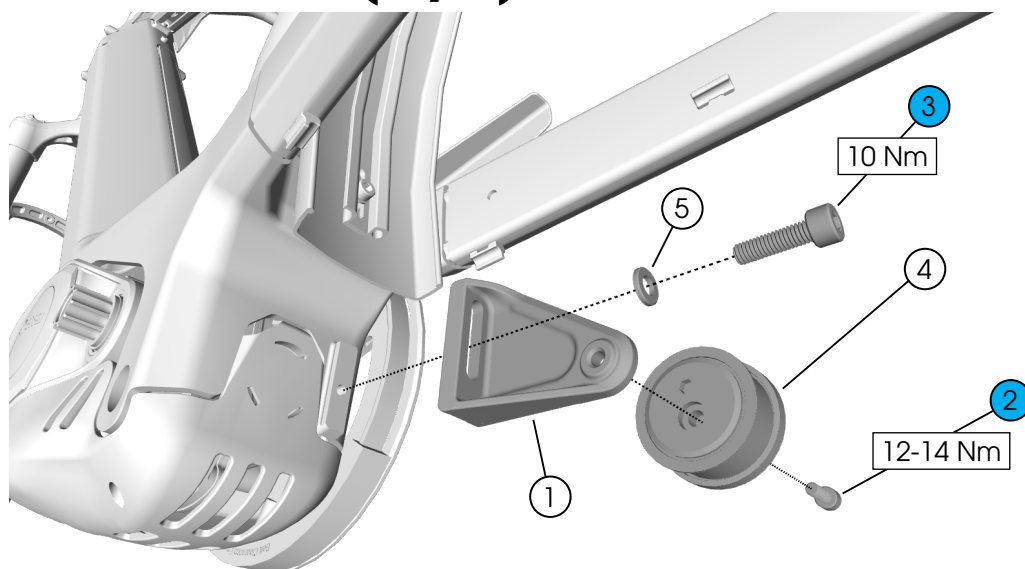

① Bracket – W5325022

② Fastener (M6 x 16 mm) – 5332528

③ Fastener (M6 x 20 mm) – W5258524

④ Idler – *TI-12-DD

⑤ Washer (M6)

*Gates part number

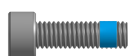

Kickstand

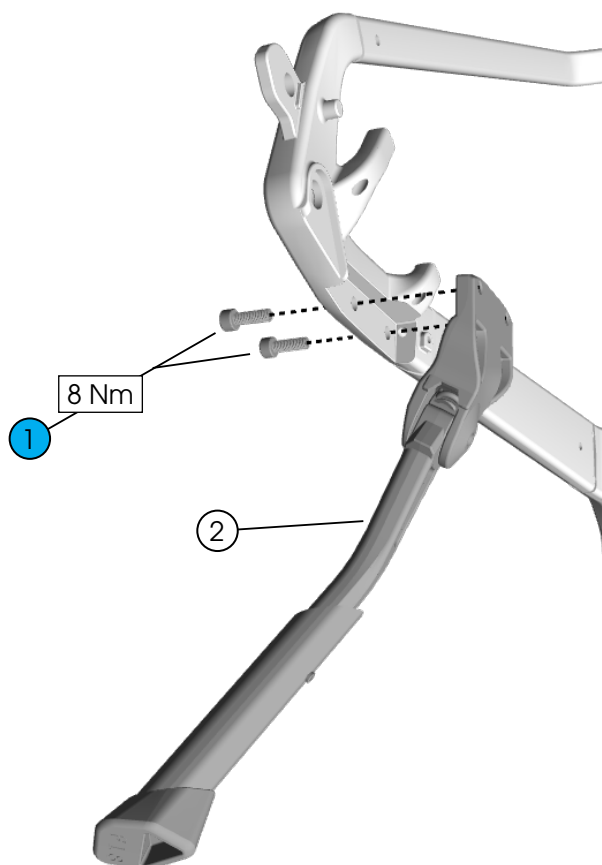

① Fasteners (M6 x 18 mm)

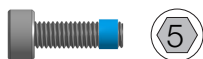

② Kickstand – 5331898

Ring lock

SOLD AFTERMARKET ONLY

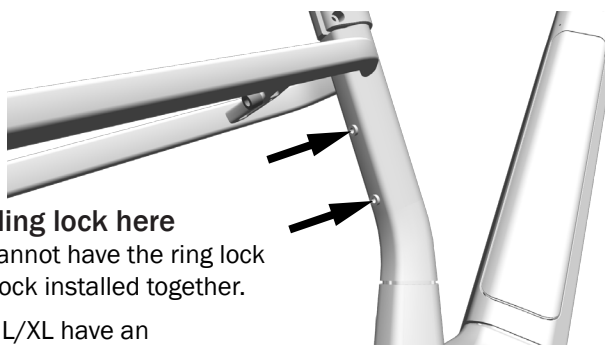
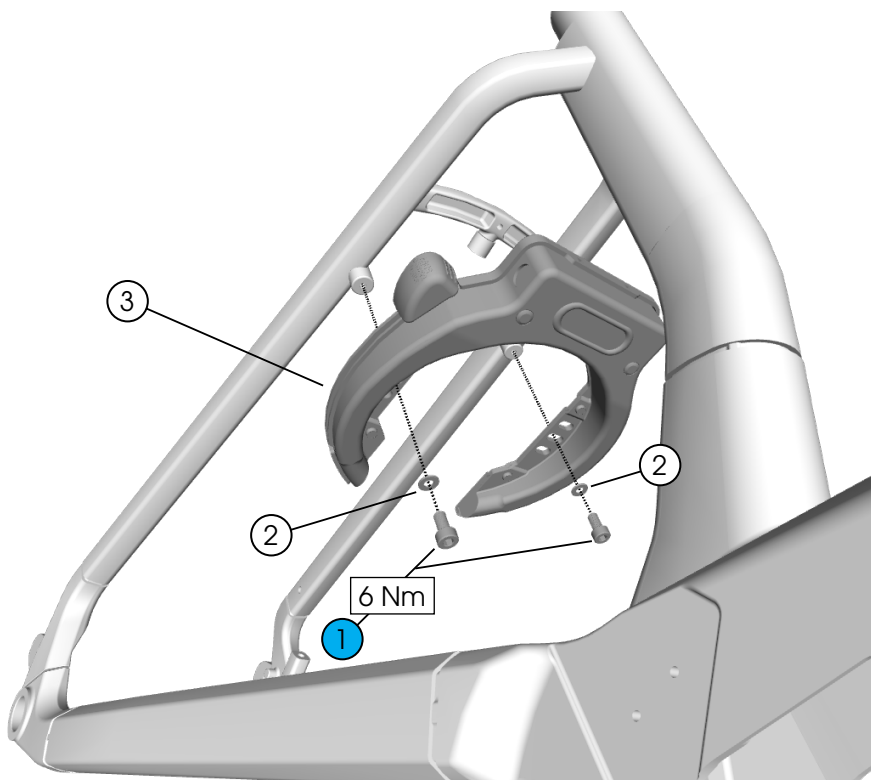

Attach folding lock here

NOTE: You cannot have the ring lock and folding lock installed together.

NOTE: Sizes L/XL have an additional mounting hole.

① Fasteners (M5 x 12 mm) – 5308514

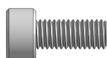

② Washers (M5) – W521137

③ Ring lock – *4650XL/4750XL

*ABUS part number

Rear derailleur hanger (Trip Pro/Trip Plus)

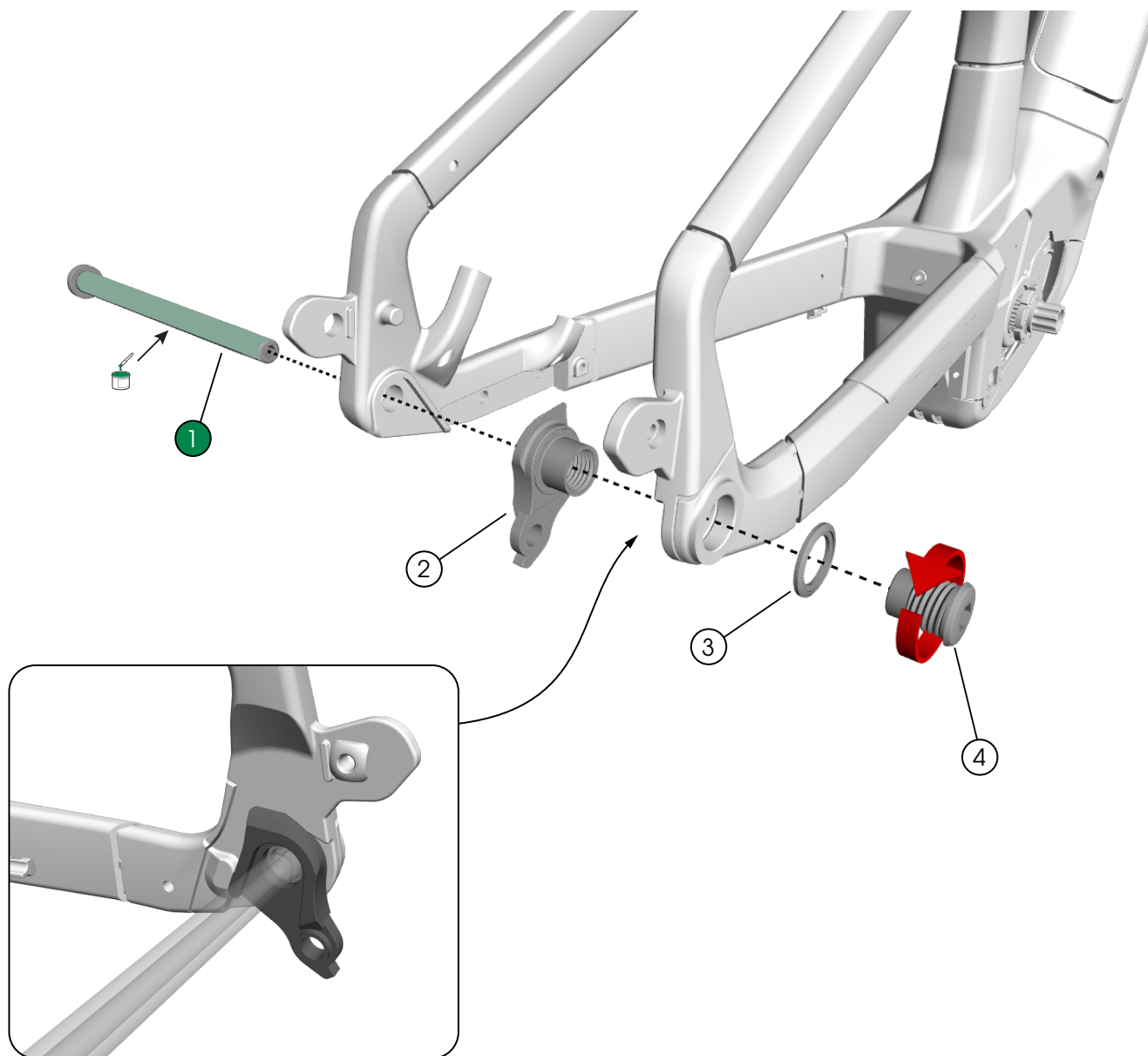

① Rear axle (M12 x 174 mm) - W600321

② Dérailleur hanger

③ Washer (30 mm)

④ Fastener (M12 x 16 mm)



W5271425

Internal gear hub (Style)

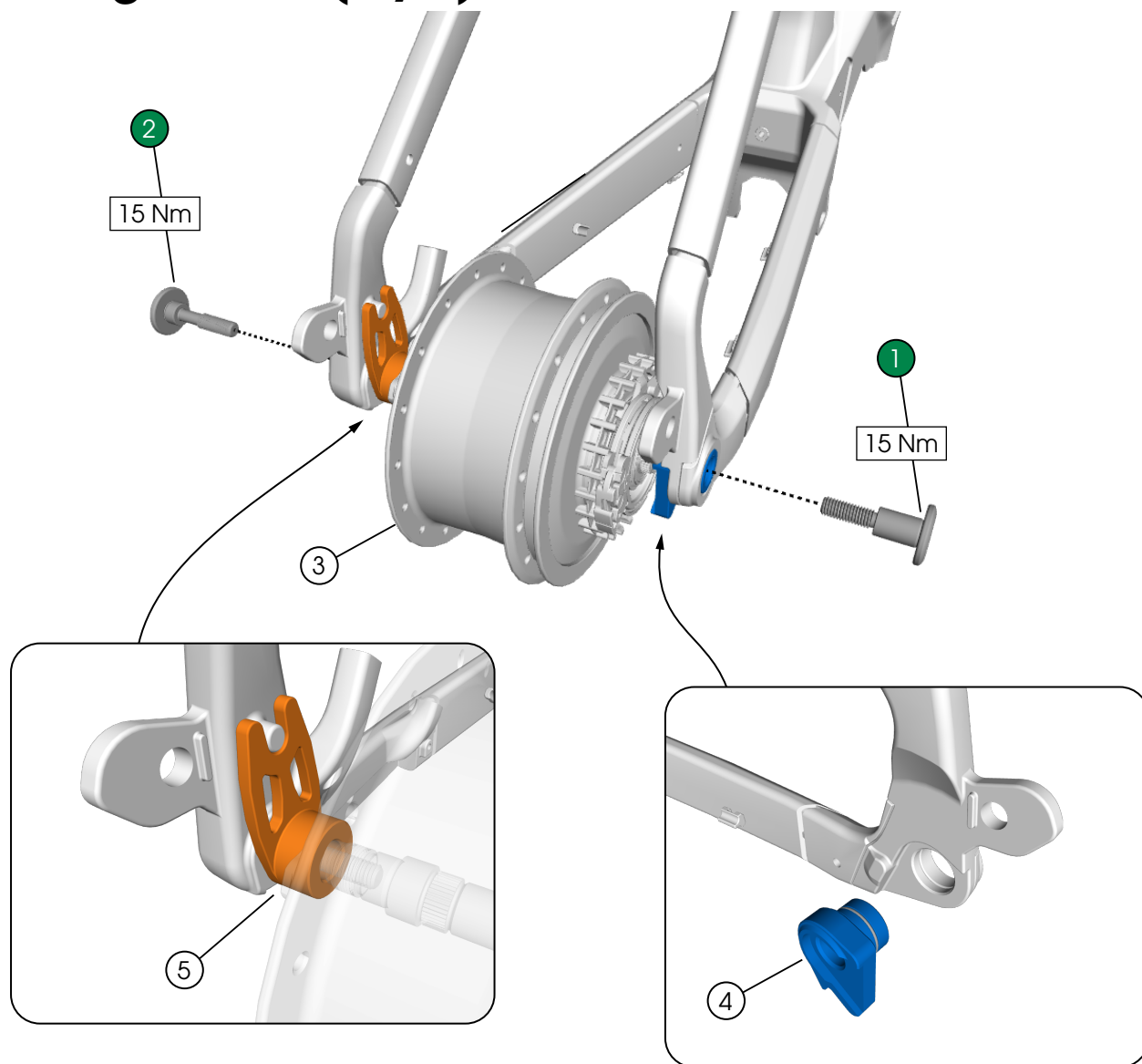

- ① Fastener – *HW-MA-1PC-UDH
- ② Fastener – *HW-MA-1PC-12TA
- ③ Internal gear hub
- ④ UDH insert – *HW-MA-INSRT-UDH
- ⑤ Reaction arm – *HW-TORQ-6



*Enviolo part number

Frame fasteners

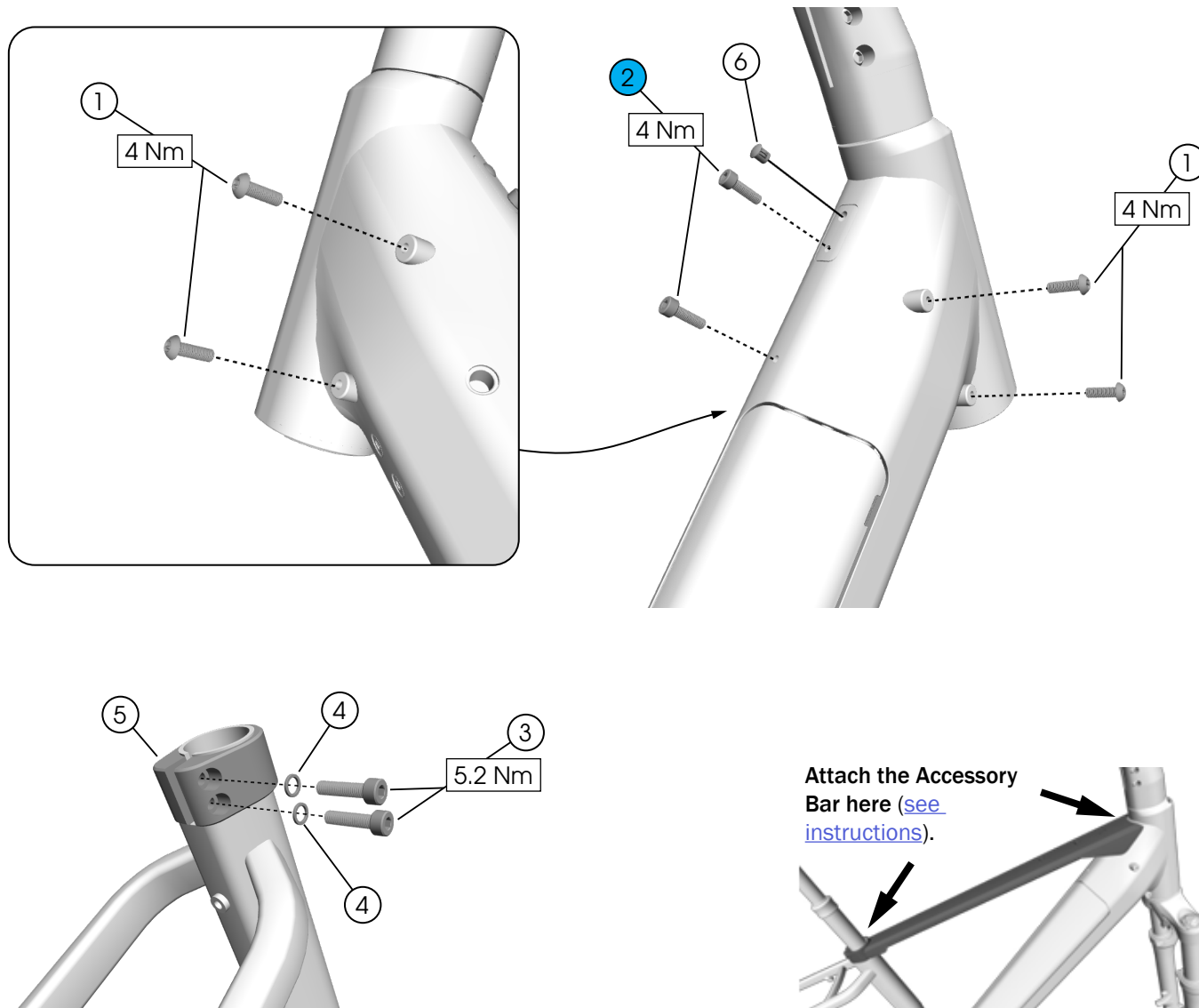

① Fasteners (M5 x 16 mm) – 5328801

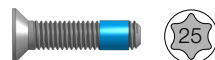

② Fasteners (M5 x 16 mm) –
*W5252789

③ Fasteners (M5 x 20 mm)



④ Washers (M5)

⑤ Seat collar – W5325704

⑥ Rivet (6.4 mm x 8 mm)

Attach the Accessory
Bar here ([see
instructions](#)).

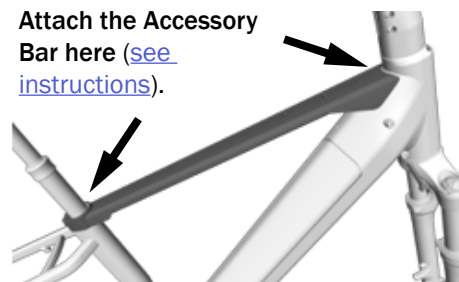

Front mudguard

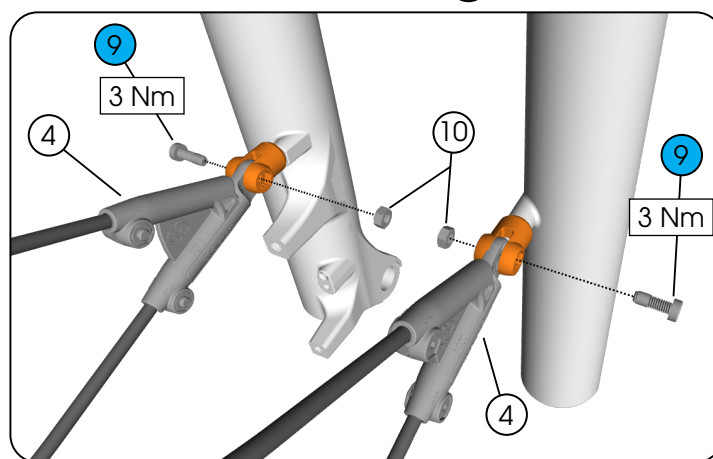
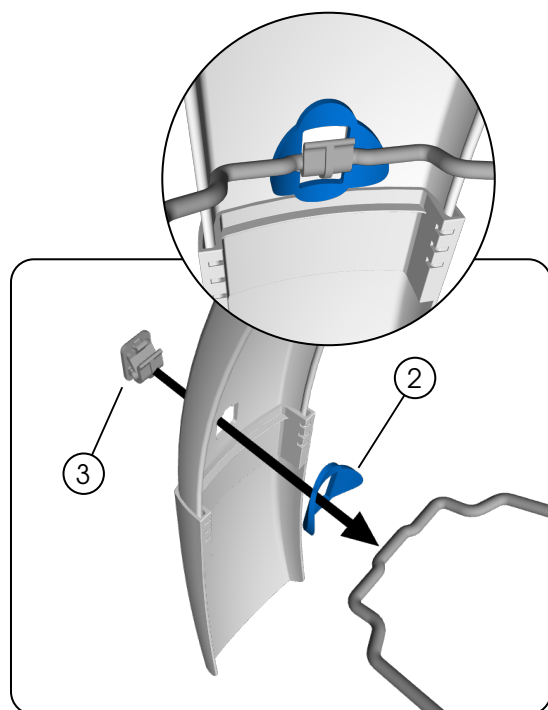
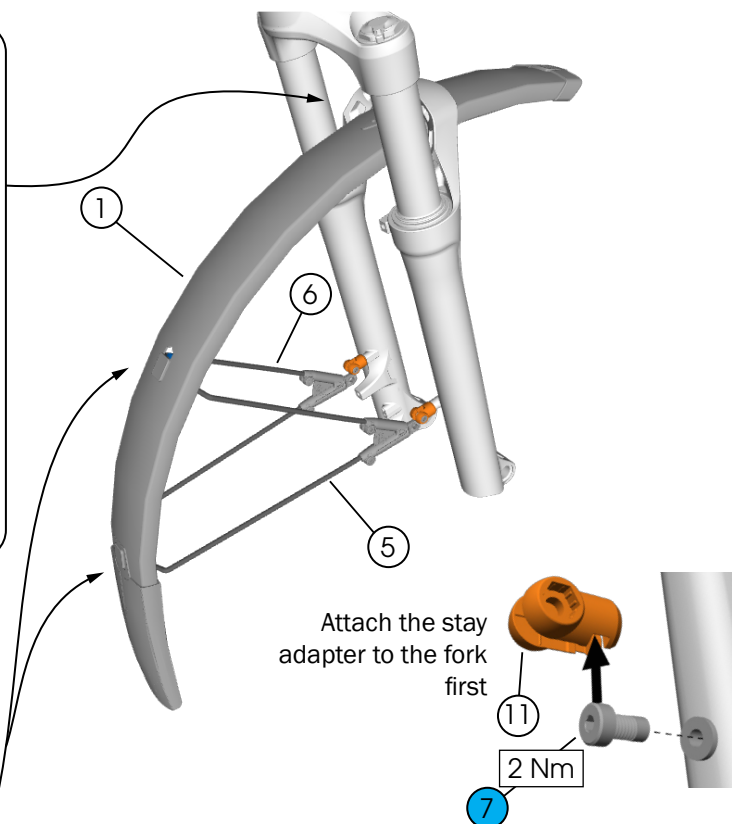
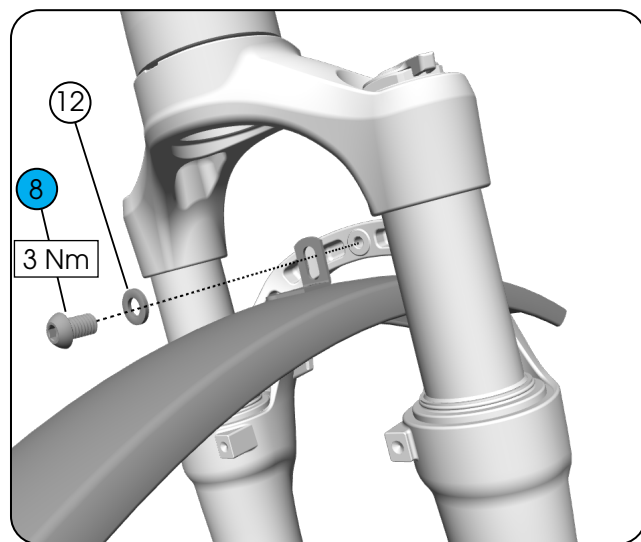

- ① Mudguard (700 x 69 mm) – W5328184
- ② Damping rubbers
- ③ Stay clips
- ④ Stay mounts – 5341283
- ⑤ Mudguard stay (265 mm) – W5338125
- ⑥ Mudguard stay (215 mm) – W5330610
- ⑦ Fasteners (M5 x 10 mm) – 5317305



- ⑧ Fastener (M6 x 10 mm)
- ⑨ Fasteners (M4 x 12 mm) – 5305635
- ⑩ Nuts, hexagon (M4) – 5,328,804
- ⑪ Stay adapters – W5326167
- ⑫ Split washer (M6) – 5317315

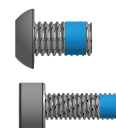

Rear rack and mudguard

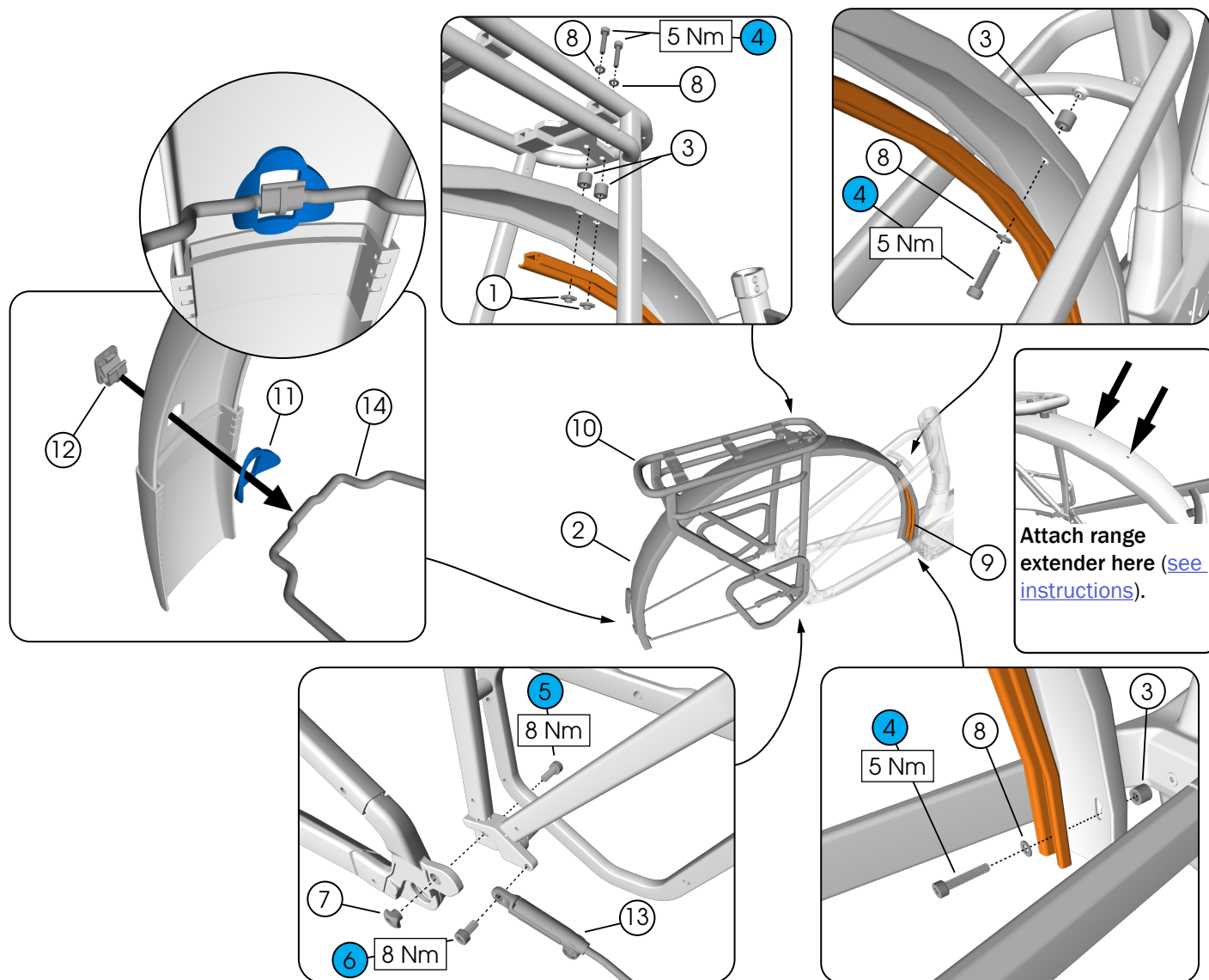

① Mounting nuts (M5) – W5251640

② Mudguard – W5328189

③ Spacers (10 mm) – 5260275

④ Fasteners (M5 x 25 mm)
– W5252787

⑤ Fasteners (M6 x 16 mm)
– 5332528

⑥ Fasteners (M5 x 10 mm)
– 5271528

⑦ Mounting nuts (M6) – W5325889

⑧ Washers (M5) – 5317316

⑨ Strut – W5328273

⑩ Rack – W5321753

⑪ Damping rubber

⑫ Stay clip

⑬ Stay mounts – 5258260

⑭ Mudguard stay (275 mm) – W5321840

5258253

Specifications

Frame

Hub OLD	Front	110 mm
	Rear	148 mm
Fork steerer tube OD	Upper	28.6 mm
	Lower	38.1 mm
Brake rotor diameter min/ max	Front	180/203 mm
	Rear	180/203 mm
Max chain ring		48T chain/55 belt
Chain line		52 mm chain/50.2 mm belt
Seat post diameter		31.6 mm