

*Diamant* 



# ZING LIGHTWEIGHT GEN 3

SERVICE MANUAL



# Contents

## Routing

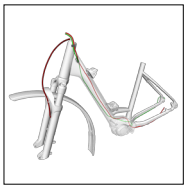

[Routing – brake and shift](#)



[Routing – e-system](#)



[Routing – lights](#)

## Headset

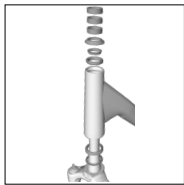

[Headset](#)

## E-system

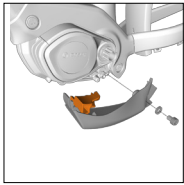

[Drive unit cover](#)

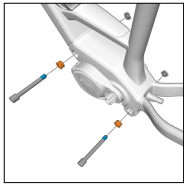

[Drive unit fasteners](#)

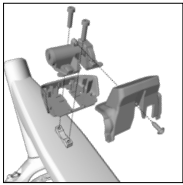

[Battery docks](#)

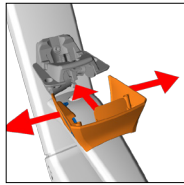

[Install the lower battery dock](#)

## Frame

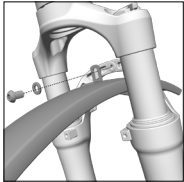

[Front mudguard](#)

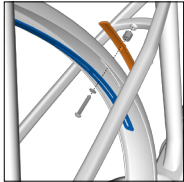

[Rear mudguard and rack](#)

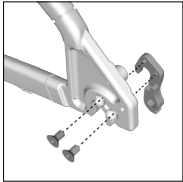

[Rear derailleur hanger](#)

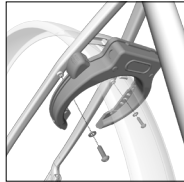

[Ring lock](#)

## Specs

Frame		
Min OLD	Front	120 mm
	Rear	135 mm
Fork steerer tube OD	Upper	28.6 mm
	Lower	35.5 mm
Brake rotor diameter min/max	Front	160/180 mm
	Rear	160/180 mm
Tire width max 700c		~27.5"
Dropout post compatible		No

\*as measured when the tire is seated on the rim

[Specifications](#)

# About this manual

## Scope

This manual contains parts diagrams, specifications (such as grease and torque values), instructions, part numbers and helpful tips. It does not contain instructions for all components (such as brake callipers). Refer to the original manufacturer for more information.

## Replacement parts

Trek recommends using only Trek OEM (original manufacturer) replacement parts.

## Additional info

The Owner's Manual is available at [Trek bikes.com/manuals](https://trekbikes.com/manuals).

## Inspect the bike

Please inspect the bicycle carefully after removal from the box and all packaging:

- Inspect all surfaces of the bicycle for damage, paying special attention to the fork legs and the seat stays (both inside and outside surfaces).
- If packaging damage is located near the front of the bicycle, remove the fork from the frame and inspect the steerer tube for damage.

## Legend

★ Cable (zip) tie

Nm Torque value



Apply appropriate threadlocker



Apply Bontrager grease

## Safety



### WARNING

#### Tighten hardware properly

Always tighten hardware to the specified torque. Over-tightening hardware could deform or break the hardware or components. Under-tightening or over-tightening hardware could cause hardware or components to become loose. Either situation could damage the bicycle and result in injury to the rider.



### WARNING

#### Re-apply threadlocker

All reused-fasteners with a pre-applied threadlocker must be cleaned with isopropyl alcohol and have new threadlocker applied before re-assembly. If a threadlocker is not applied, the fasteners may loosen, which could damage the bicycle and result in injury to the rider.

## Routing - brake and shift

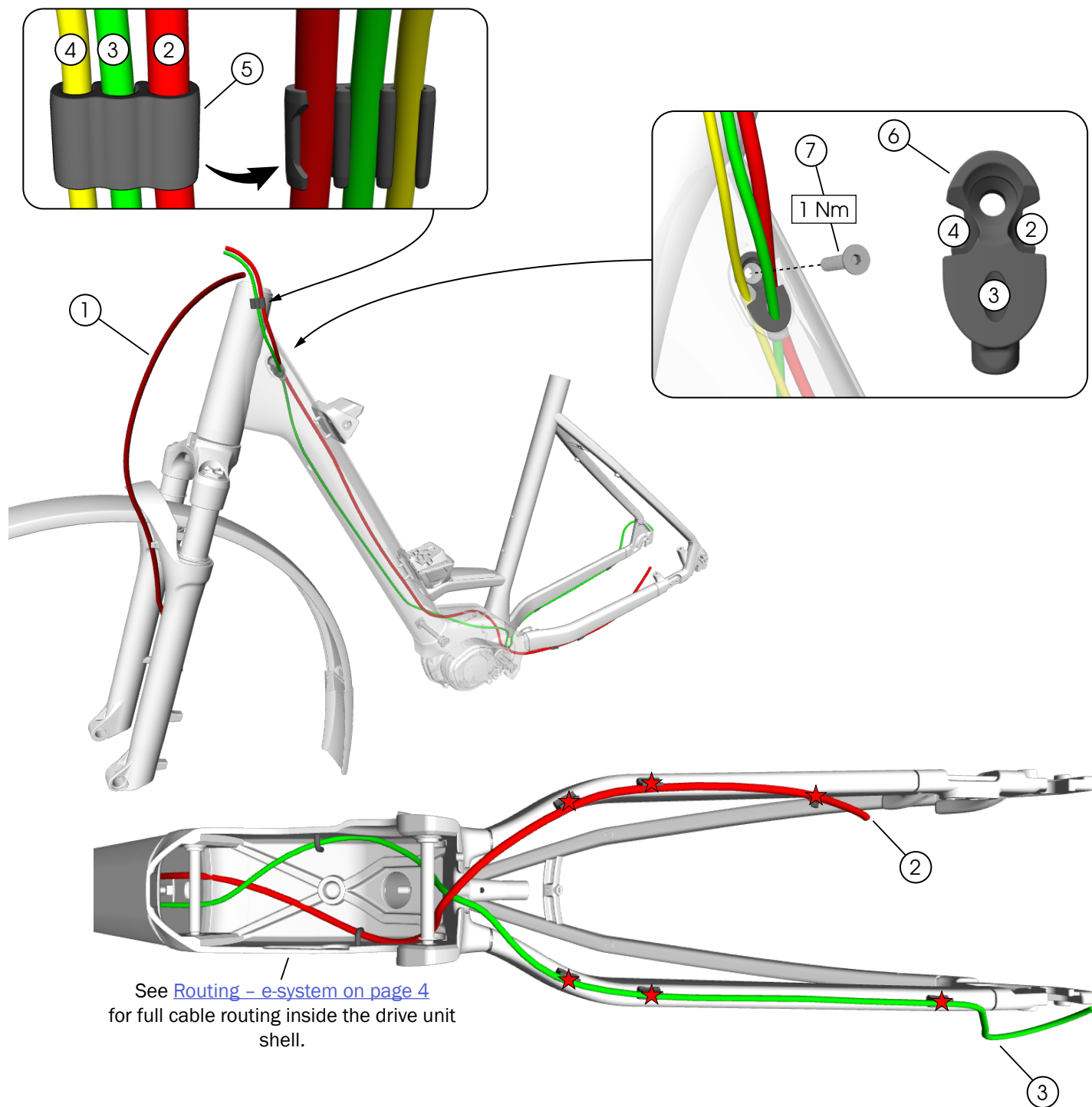

① Front brake hose

② Rear brake hose

③ Rear shift cable

④ Remote cable - \*EB12.120.005

⑤ Cable clip - W5319628

⑥ Cable guide - W5257896

⑦ Fastener (M4 x 16 mm)

②.5 - W532763



## Routing - e-system

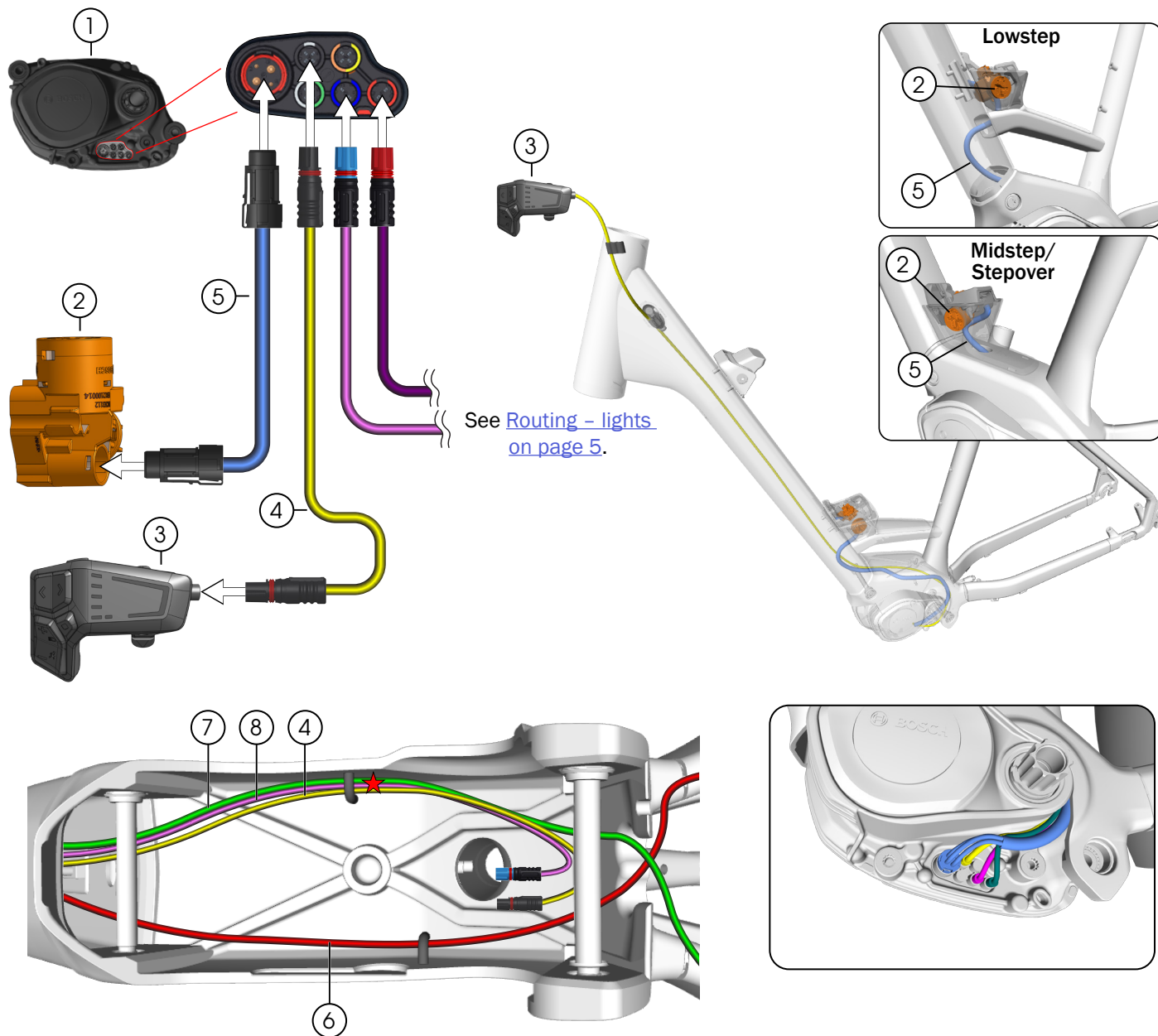

① Drive unit – \*EB11.100.00E

② Battery adapter – \*EB12.100.014

③ Remote – \*EB13.100.00E-VE8

④ Remote cable – \*EB12.120.005

⑤ Battery cable –   
     Lowstep (500) mm – \*EB12.120.00T  
     Midstep/Stepover (400) mm – \*EB12.120.00V

⑥ Rear brake hose

⑦ Rear shift cable

⑧ Front light wire – \*EB12.120.00H

\*Bosch part number

# Routing - lights

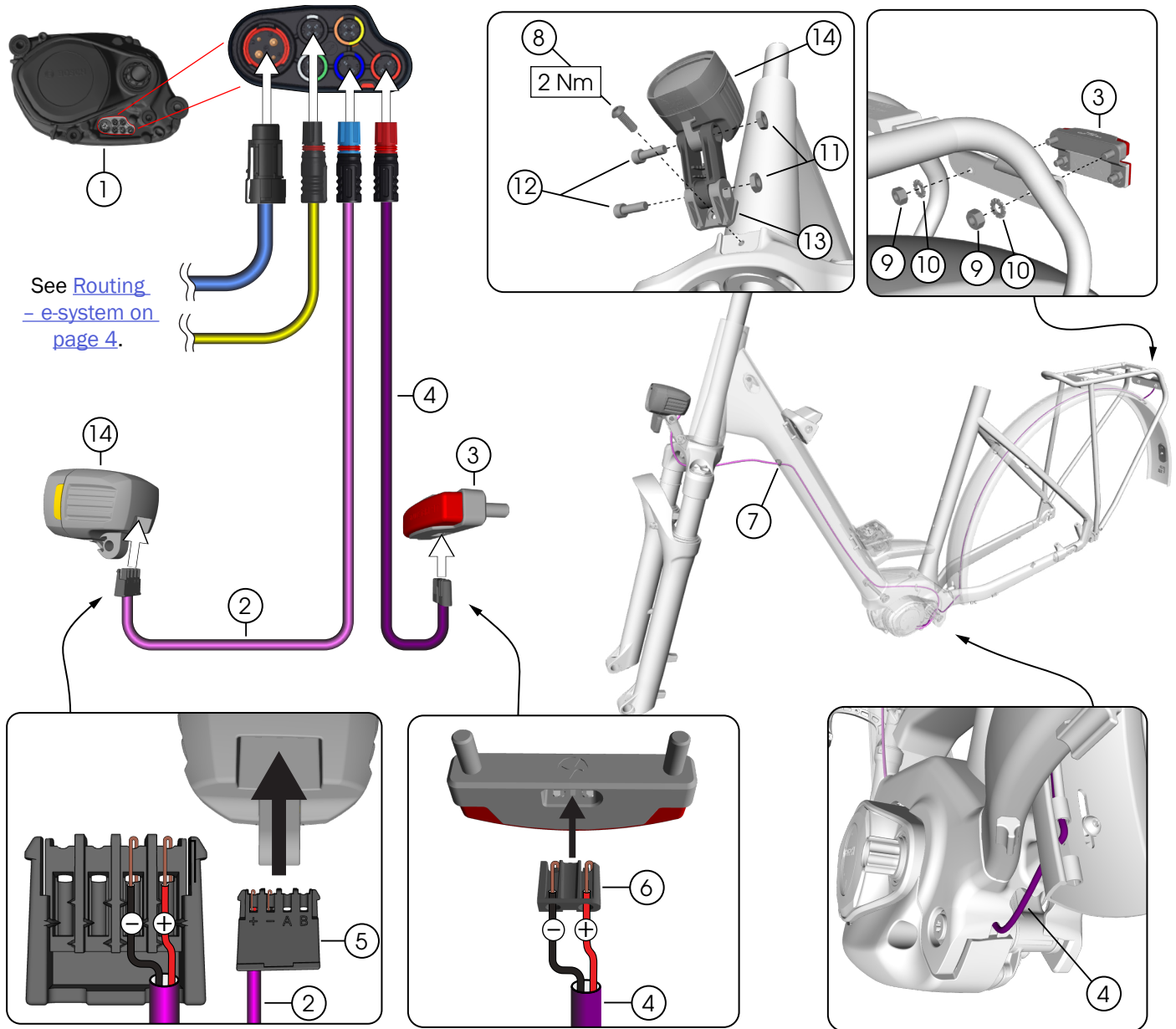

- ① Drive unit - \*EB11.100.00E
- ② Front light wire - \*EB12.120.00H
- ③ Rear light - W5328257
- ④ Rear light wire - \*EB12.120.00F
- ⑤ Connector, front - 5331539
- ⑥ Connector, rear - 5307542
- ⑦ Grommet
- ⑧ Fastener (M6 x 12 mm)

- ⑨ Nuts (M6)
- ⑩ Serrated washers
- ⑪ Nuts
- ⑫ Fasteners
- ⑬ Mount
- ⑭ Front light

\*Bosch part number

④ } W5304404



# Headset

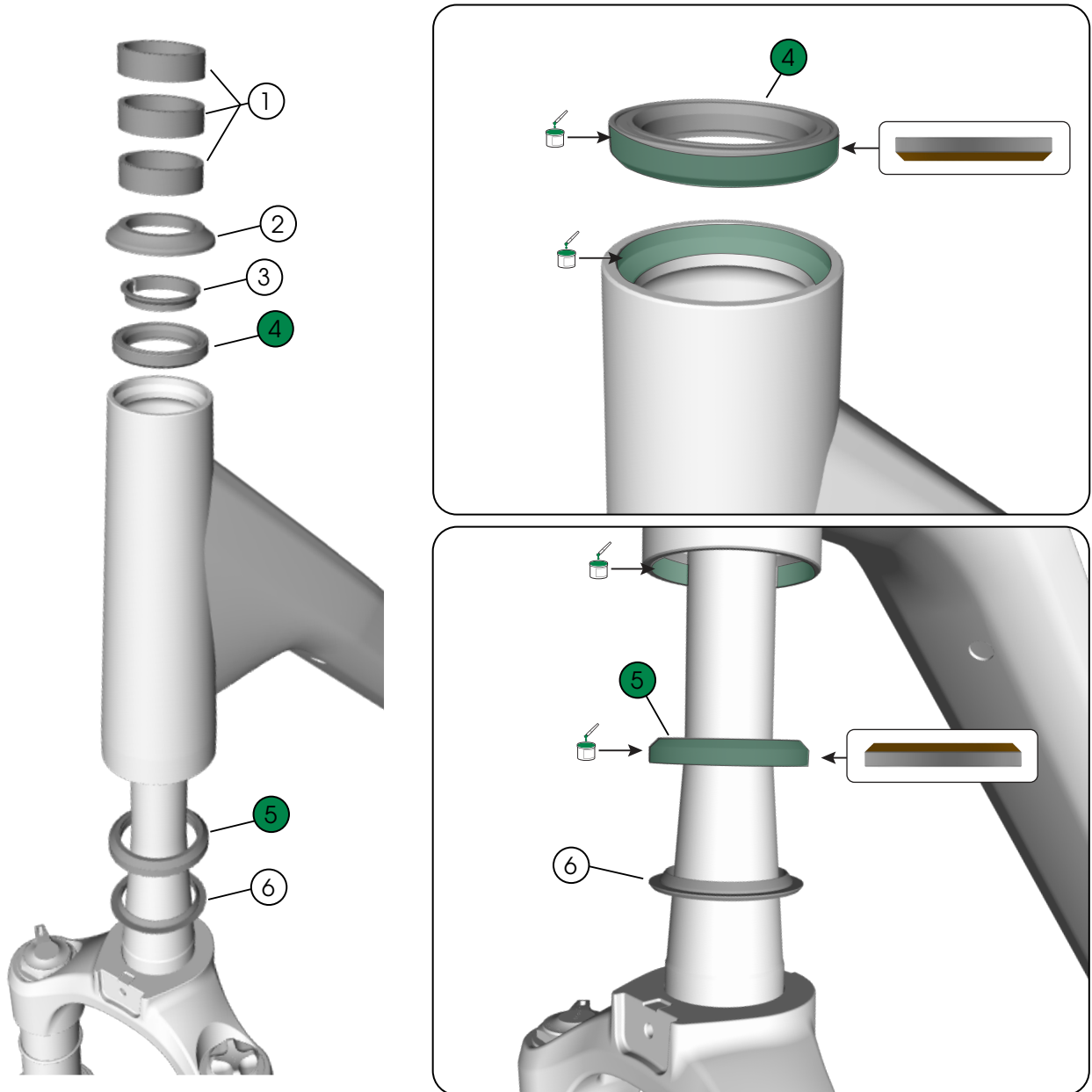

- ① Spacers (10 mm) – 5253929
- ② Bearing top cover – W5283853
- ③ Compression ring – W532842
- ④ Bearing, upper – W531676
- ⑤ Bearing, lower – W532843
- ⑥ Crown race (1.5"/38.1 mm) – W532844

## Drive unit cover

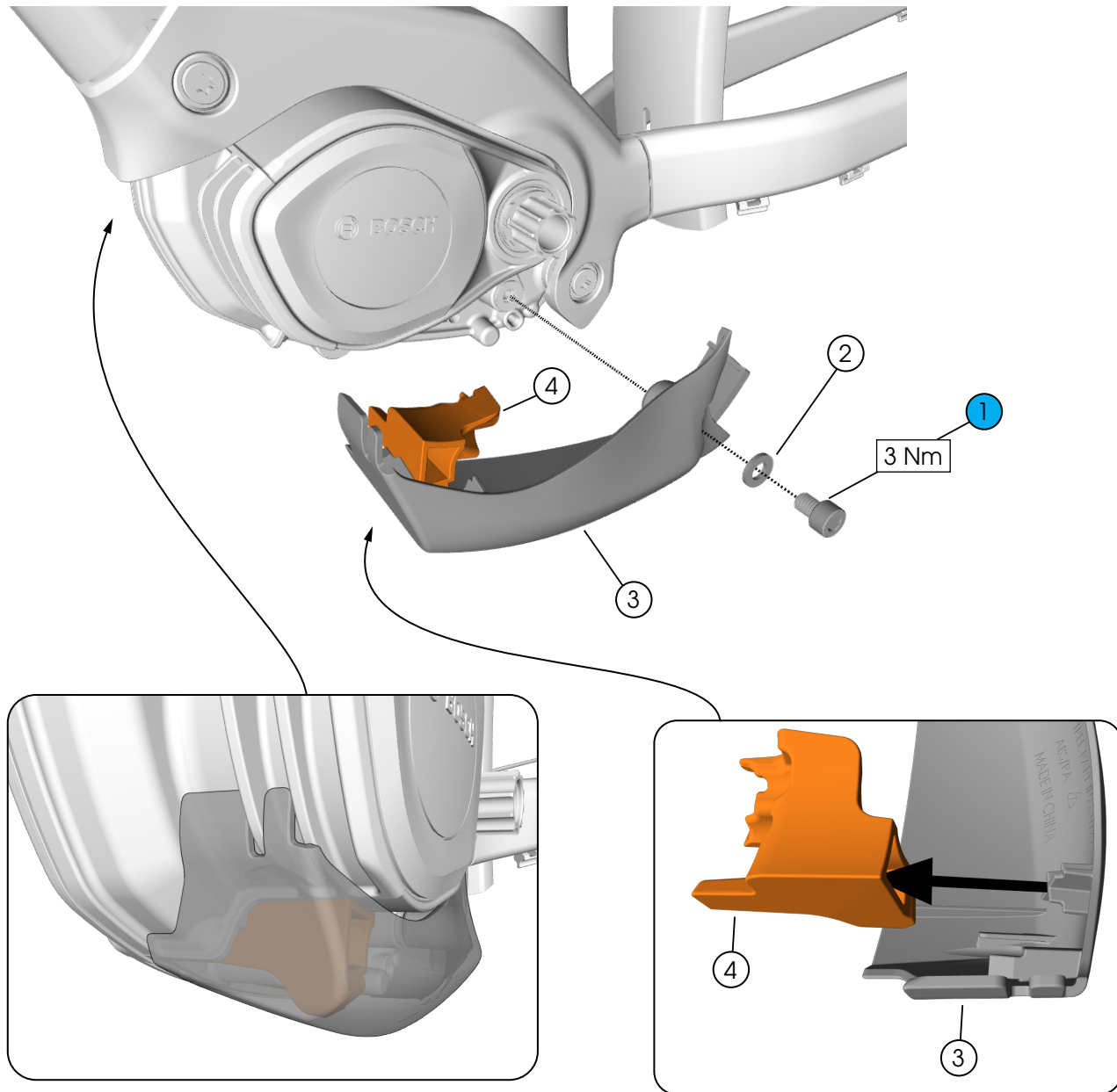

- ① Fastener (M6 x 12 mm) – 5328800
- ② Washer (M6) – 5317317
- ③ Drive unit cover – W5320172
- ④ Bosch Connect Module holder – \*EB13.900.018

\*Bosch part number



## Drive unit fasteners

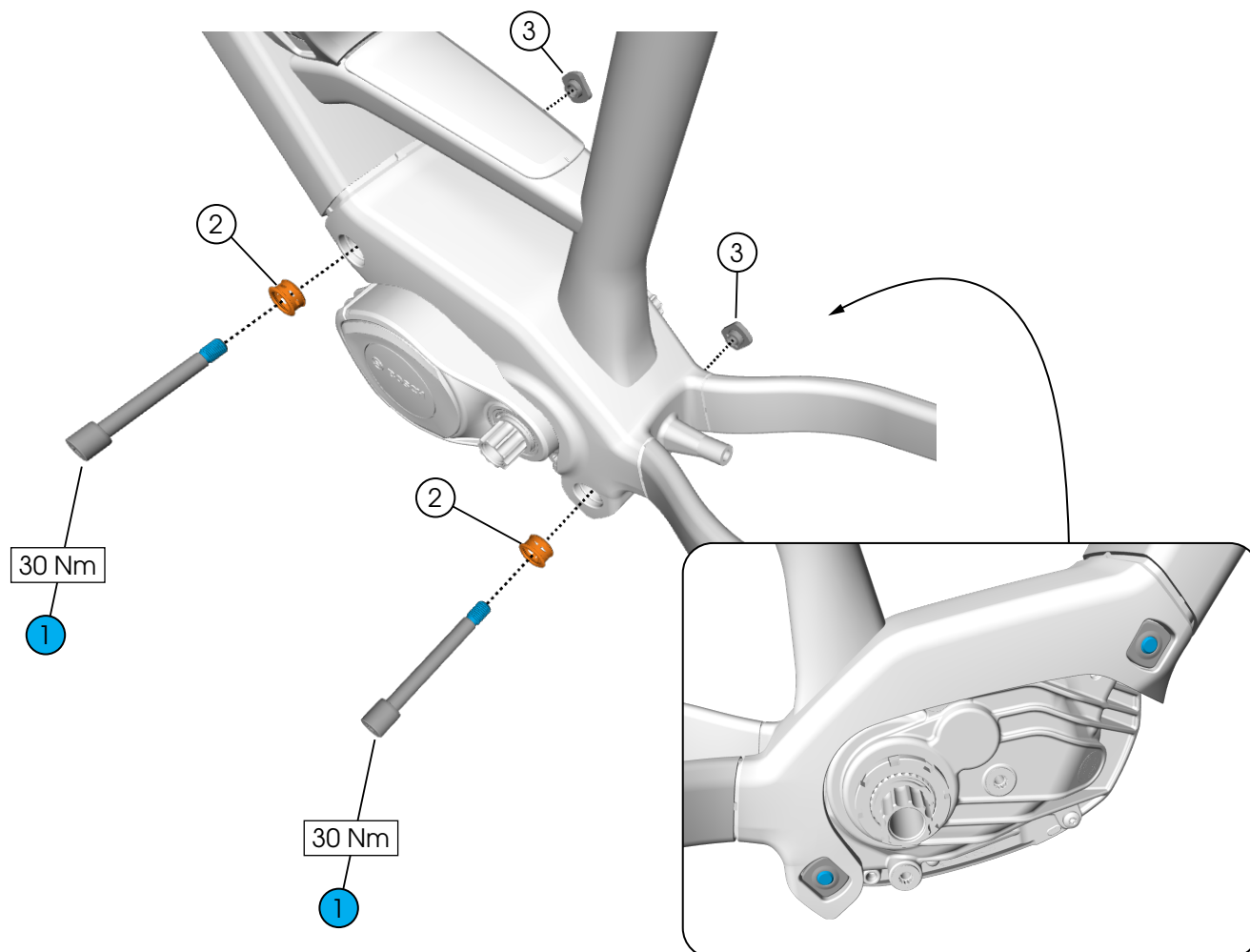

① Fasteners (M8 x 68.7 mm) – \*EB11.200.0N9



② Sleeves – \*EB11.200.0GK

③ Nut-squares – \*EB11.200.03C

\*Bosch part number

**NOTE:** Use a Bosch press-in/out tool (such as Cyclus P/N 2124349) to install the sleeves.

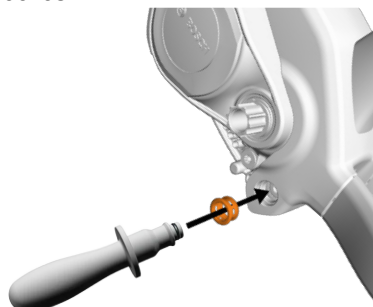

## Remove the drive unit

1. Unplug the cables to the drive unit.
2. With your hand under the drive unit to support it, remove the fasteners.
3. Slowly lower the drive unit.

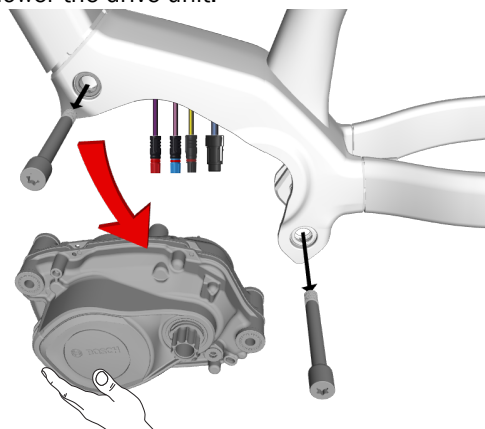

## Battery docks

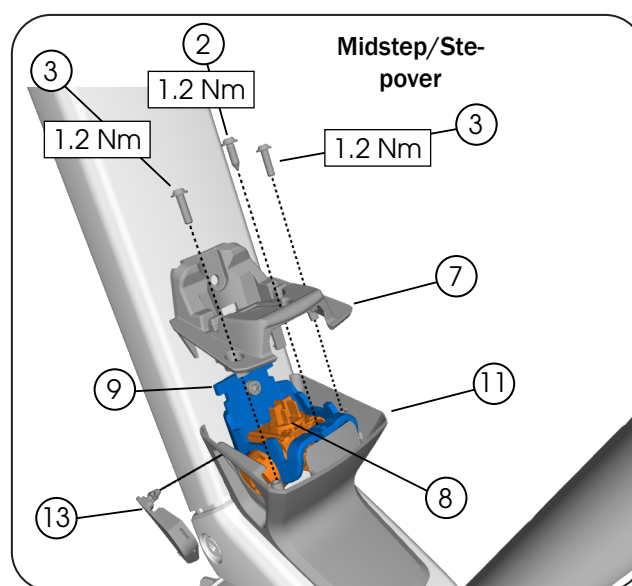
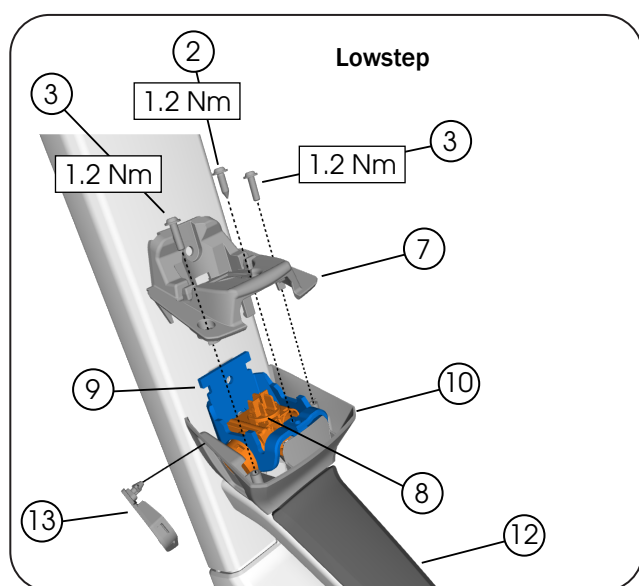
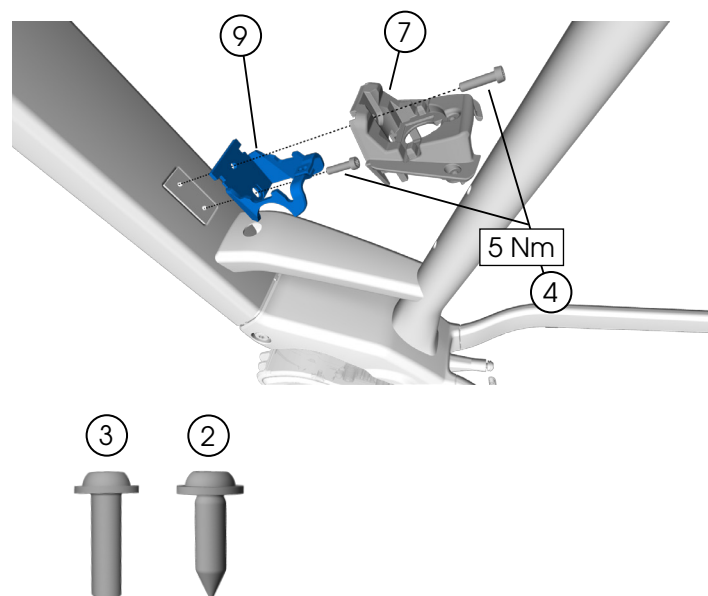
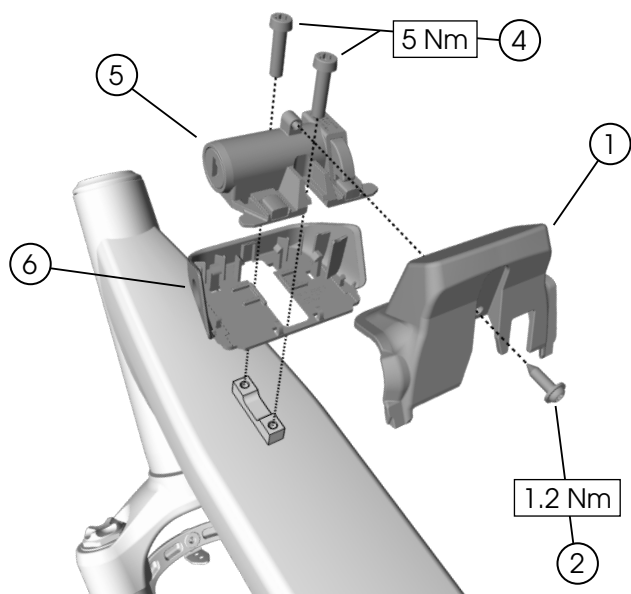

- ① Lock housing - \*EB12.200.01D
- ② Fasteners (M3.5 x 12 mm)  - \*1270.016.418
- ③ Fasteners (M3.5 x 12 mm)  - \*1270.016.417
- ④ Fasteners (M5 x 20 mm)  - \*EB12.200.01B
- ⑤ Lock - W5284889
- ⑥ Cover - W5285712
- ⑦ Mounting plate - \*EB12.200.0AR

- ⑧ Battery adapter - \*EB12.100.014
- ⑨ Fixing plate - \*EB12.200.03J
- ⑩ Shroud (Lowstep) - W5320169
- ⑪ Shroud (Midstep/Stepover) - W5320170
- ⑫ Guard (Lowstep) - W5320171
- ⑬ Connector cover - \*EB12.200.0C7

\*Bosch part number



# Install the lower battery dock

1. Attach the fixing plate and mounting plate to the frame.

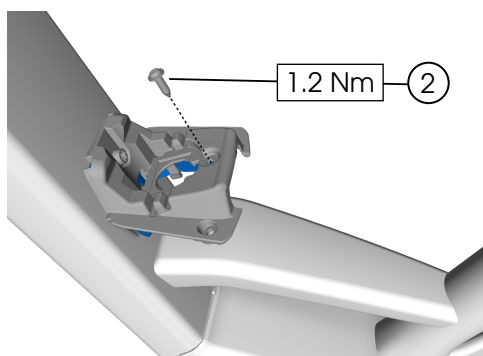
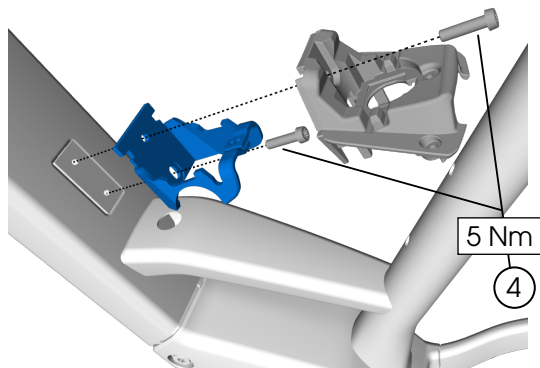

2. Insert the battery adapter and connect the battery cable.

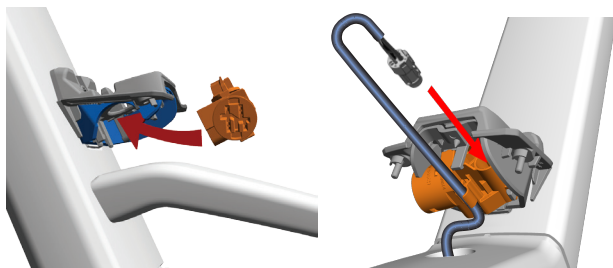

3. Insert the connector cover into the shroud.



4. Install the shroud – pulling out the sides as you snap it into place.

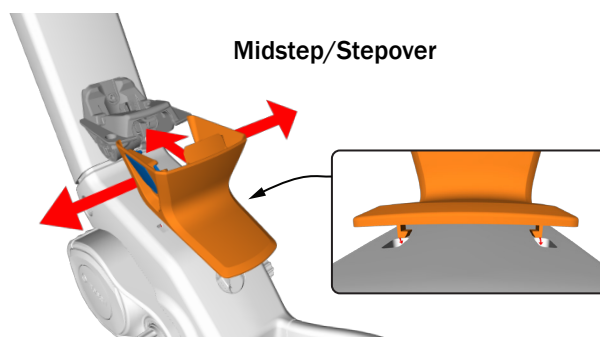
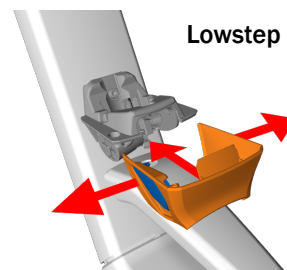

5. Install the other two fasteners.

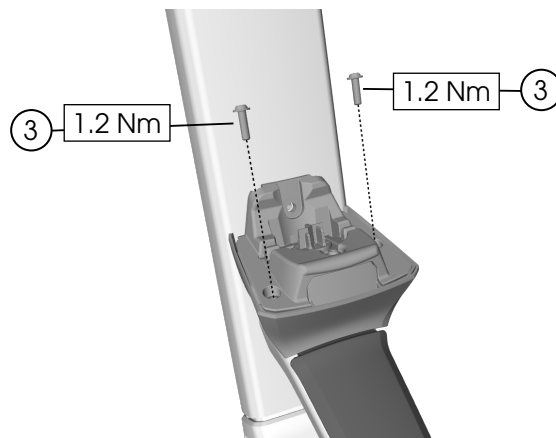

# Front mudguard

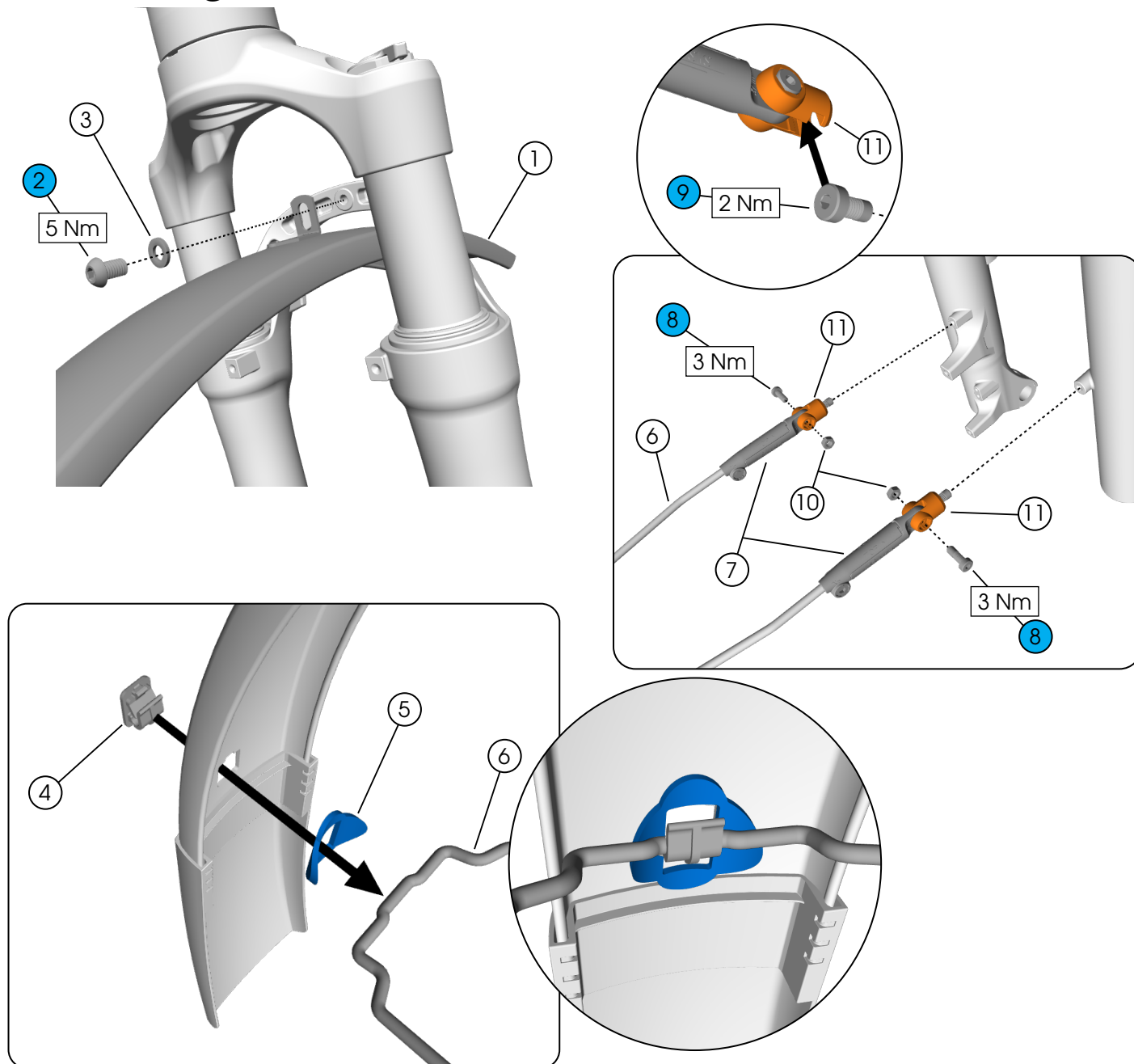

① Front mudguard (700 x 65 mm) – W5321838

② Fastener (M6 x 10 mm)



③ Split washer (M6) – 5317315

④ Stay clip

⑤ Damping rubber

⑥ Mudguard stay (275 mm) – W5321840

5258253

⑦ Stay mounts – 5258260

⑧ Fasteners (M4 x 12 mm)

②.5 – 5305635

⑨ Fasteners (M5 x 10 mm)

③ – 5317305

⑩ Nuts (M4) – 5328804

⑪ Stay adapters – W5326167



# Rear mudguard and rack

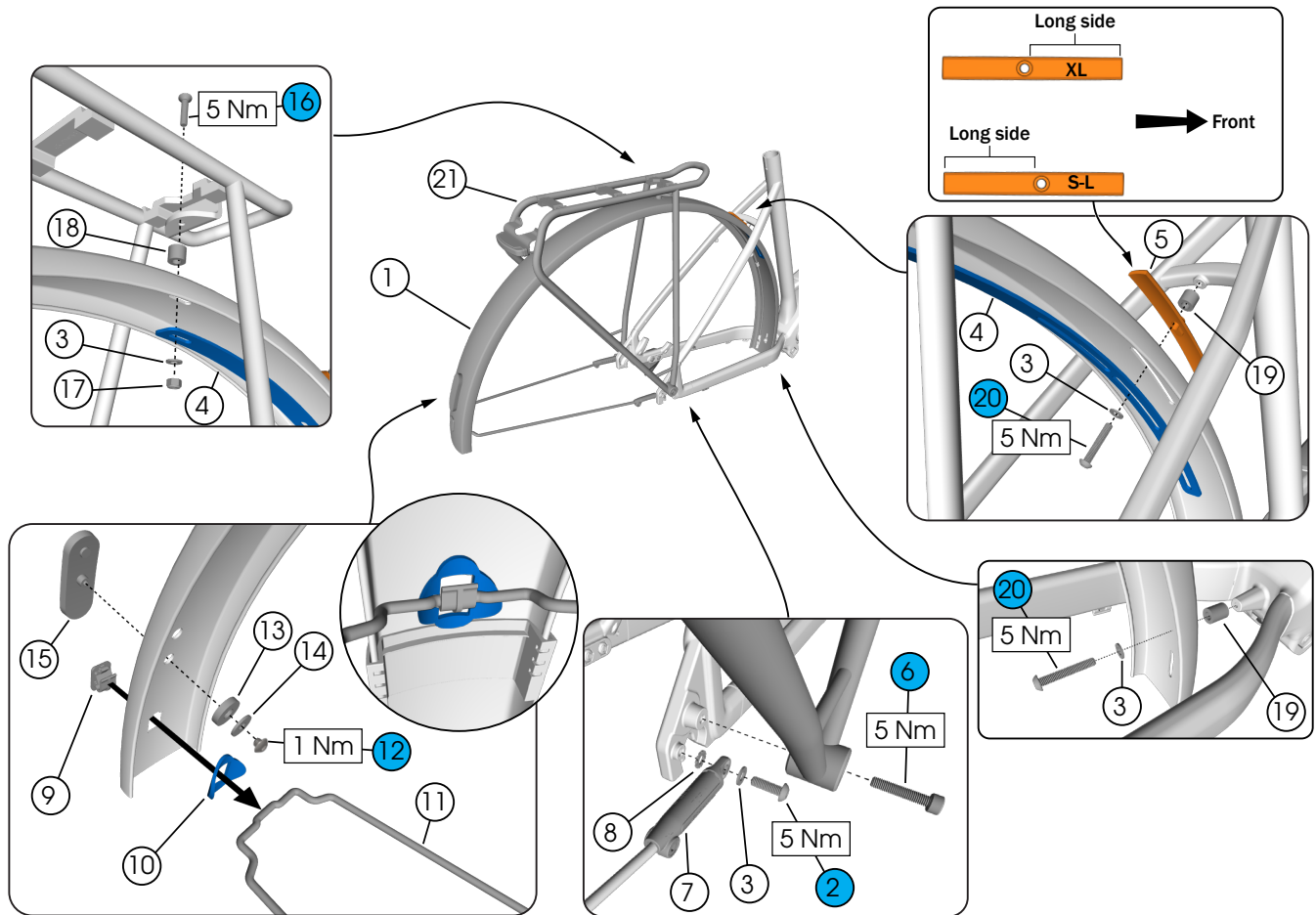

① Rear mudguard (700 x 65 mm) – W5321843

② Fasteners (M5 x 16 mm) ③ – 5328801

③ Washers (M5) – W521137

④ Mudguard strut – W600320

⑤ Slot cover (65 mm) – W1049294

⑥ Fasteners (M5 x 25 mm) ④ – 5,257,031

⑦ Stay mounts – 5258260

⑧ Serrated washers

⑨ Stay clip } 5258253

⑩ Damping rubber

⑪ Mudguard stay (335 mm) – W5321844

⑫ Fastener (M3 x 5 mm)

⑬ Spacer

⑭ Washer (M5)

⑮ Reflector

⑯ Fastener (M5 x 25 mm) ③ – 5328803

⑰ Nylock-nut (M5) – 5317577

⑱ Spacer (15 mm)

⑲ Spacer (10 mm)

⑳ Fastener (M5 x 30 mm) ③ – 5328802

㉑ Rack – W5284844

③ } W5326166

③ – 5328803

③ } 5260275

③ – 5328802

## Rear derailleur hanger

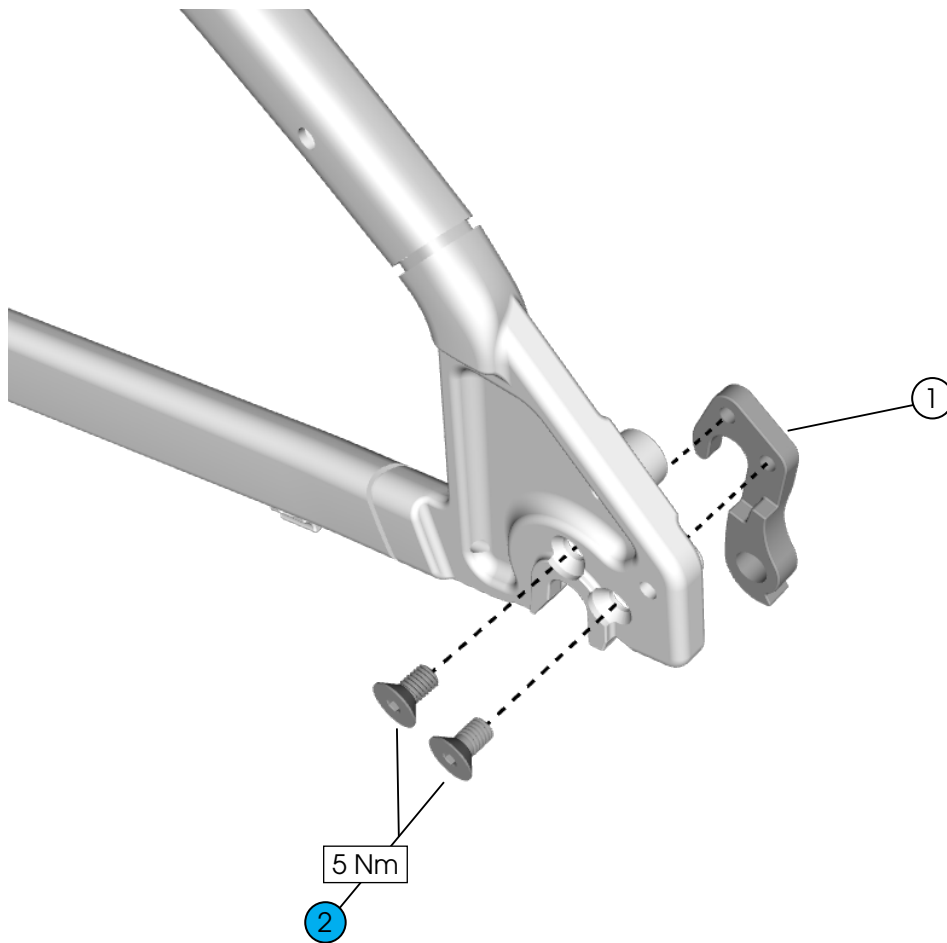

① Rear derailleur hanger – W322175

② Fasteners (M5 x 9 mm)

③ – W300580

# Ring lock

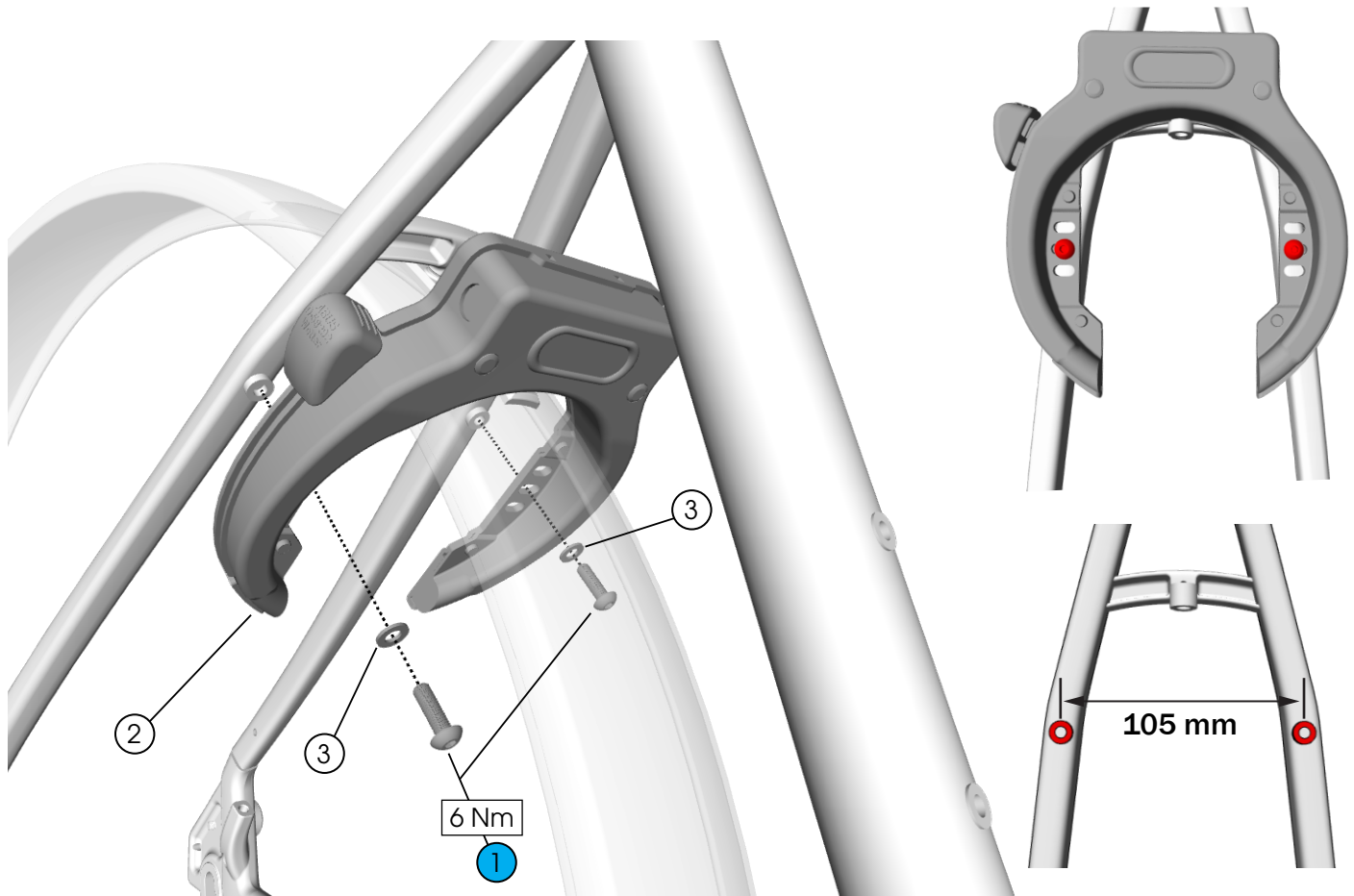

① Fasteners (M5 x 16 mm)

③ - 5328801

② Ring lock

③ Washers (M5) - 5317316



# Specifications

## Frame

<b>Hub OLD</b>	Front	100 mm
	Rear	135 mm
<b>Fork steerer tube OD</b>	Upper	28.6 mm
	Lower	38.1 mm
<b>Brake rotor diameter min/max</b>	Front	160/180 mm
	Rear	160/180 mm
<b>Tyre width max 650b</b>		*2.6"/66 mm
<b>Dropper post compatible</b>		No

*\*as measured when the tyre is seated on the rim*

## Chain line/chain ring

Chainline	Max chain ring teeth (T)		
	Small	Large	Single (1x)
52 mm	—	—	40T